



## St. Marys Square, W5

£799,950

A fantastic two bedroom boutique cottage originally constructed in 2017. One of four properties set behind private gates with an upside down living arrangement. There are two double bedrooms and a spacious, open plan kitchen/reception room with vaulted ceilings on the first floor.

St. Marys Square is ideally located for Ealing Broadway and South Ealing stations with Elizabeth, Central, District, Piccadilly and Nation Rail lines. There are numerous local eateries along with well regarded and sought after local schools.

### Features

- Two Double Bedrooms
- Residents Parking
- Gated Development
- No Onward Chain
- Close To Station
- Constructed in 2017

# St. Marys Square, London, W5



**First Floor**

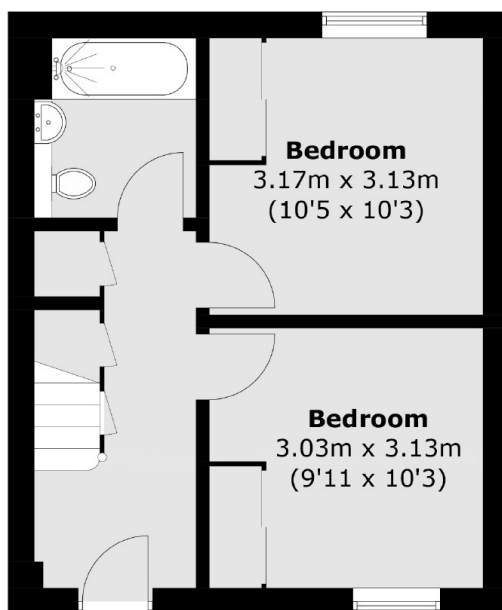

**Ground Floor**

Total area (approx.): 64.7 sq. m (696.4 sq. ft)