



Connaught Road, W13

£525,000

This two double bedroom ground floor garden flat with large windows and lots of natural light has been modernised and extended by the current owner. There is a large living room with high ceilings and a separate kitchen, along with a private and secluded rear garden that is also West facing.

Connaught Road is located just moments from West Ealing station with the new Elizabeth Line making commuting a breeze. There is a wide range of shops and amenities with a Waitrose superstore at the end of the street, along with plenty of gyms, restaurants and amenities.

Features

- Ground Floor
- Private Garden
- Period Conversion
- Next To Station

Connaught Road, London, W13

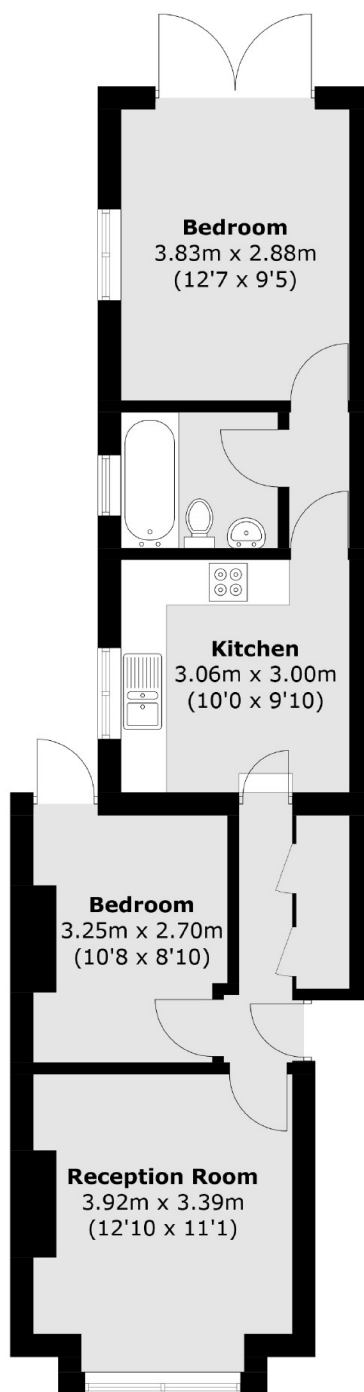

Total area (approx.): 54.4 sq. m (585.6 sq. ft)