



Warwick Road, W5

£599,950

This characterful period conversion occupies the entire top floor and has two large double bedrooms. There is an open-plan kitchen/living area that has been opened up to benefit from the South facing natural light. There is allocated off street parking and a share of the freehold.

Located on one of Ealing's premier residential roads just moments from Ealing Common with Ealing Common station just half a mile and Ealing Broadway three quarters of a mile away.

Features

- Two Double Bedrooms
- Top Floor
- Period Conversion
- Allocated Parking
- Share Of Freehold
- Attic Storage

Warwick Road, London, W5

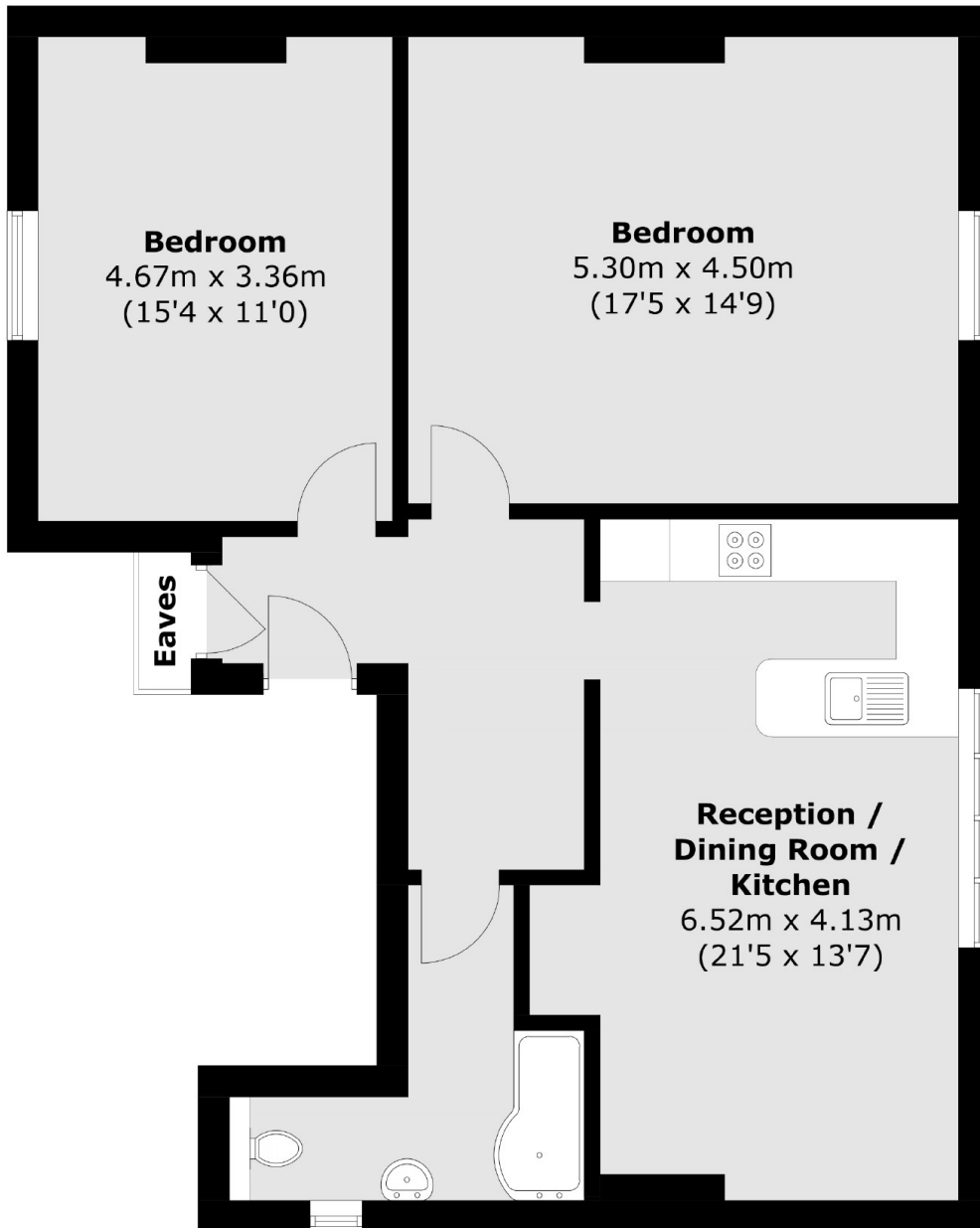

Total area (approx.): 80.5 sq. m (866.5 sq. ft)
(Excluding Eaves)