



St. Pauls Close, W5

£600,000

This three bedroom mid terrace family home is located right next to the green space of Ealing Common. Presented in clean and neutral condition throughout, the property would benefit from further modernisation also. A perfect investment opportunity or first home.

Situated just moments from Ealing Common with the Piccadilly line just half a mile away. Ealing Broadway with its Elizabeth Line, Central, District and Nation Rail services is less than a mile.

Features

- Mid Terrace Home
- Three Bedrooms
- Residential Area
- Freehold House
- Ealing Common Location
- No Onward Chain

St. Pauls Close, London, W5

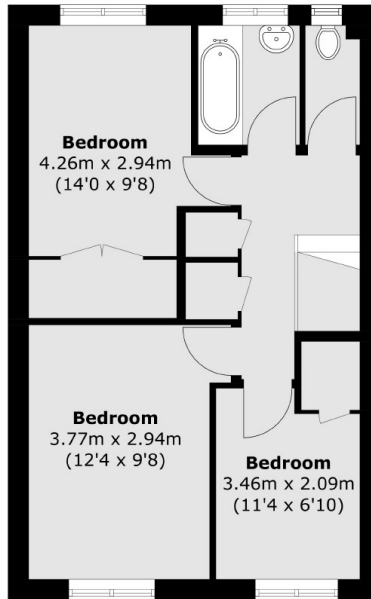

To First Floor

Garden

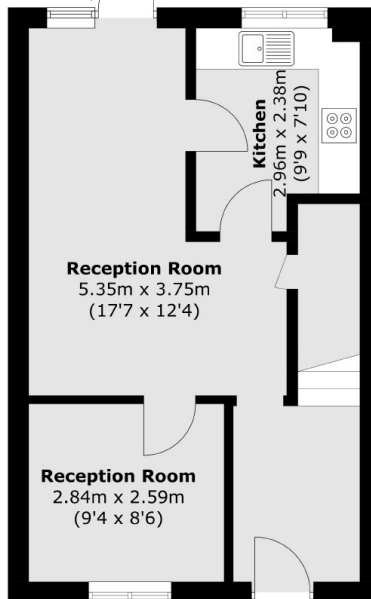

Ground Floor

Total area (approx.): 77.8 sq. m (837.3 sq. ft)