



Madeley Road, W5

£575,000

This characterful split level top floor two double bedroom period conversion has a south facing private terrace with views over the communal gardens below. There is a spacious living room, separate kitchen and modern bathroom having been recently updated by the current owners.

Located approximately half a mile from Ealing Broadway with its wide range of shops and amenities and transport hub with the new Elizabeth line, Central and District lines. Vehicular access to the A40 and M4 is easily accessible via the North Circular. North Ealing, Piccadilly Line, is also a short walk.

Features

- Two Double Bedrooms
- Private Roof Terrace
- Share Of Freehold
- Recently Renovated
- Communal Gardens
- No Onward Chain

Madeley Road,
London, W5

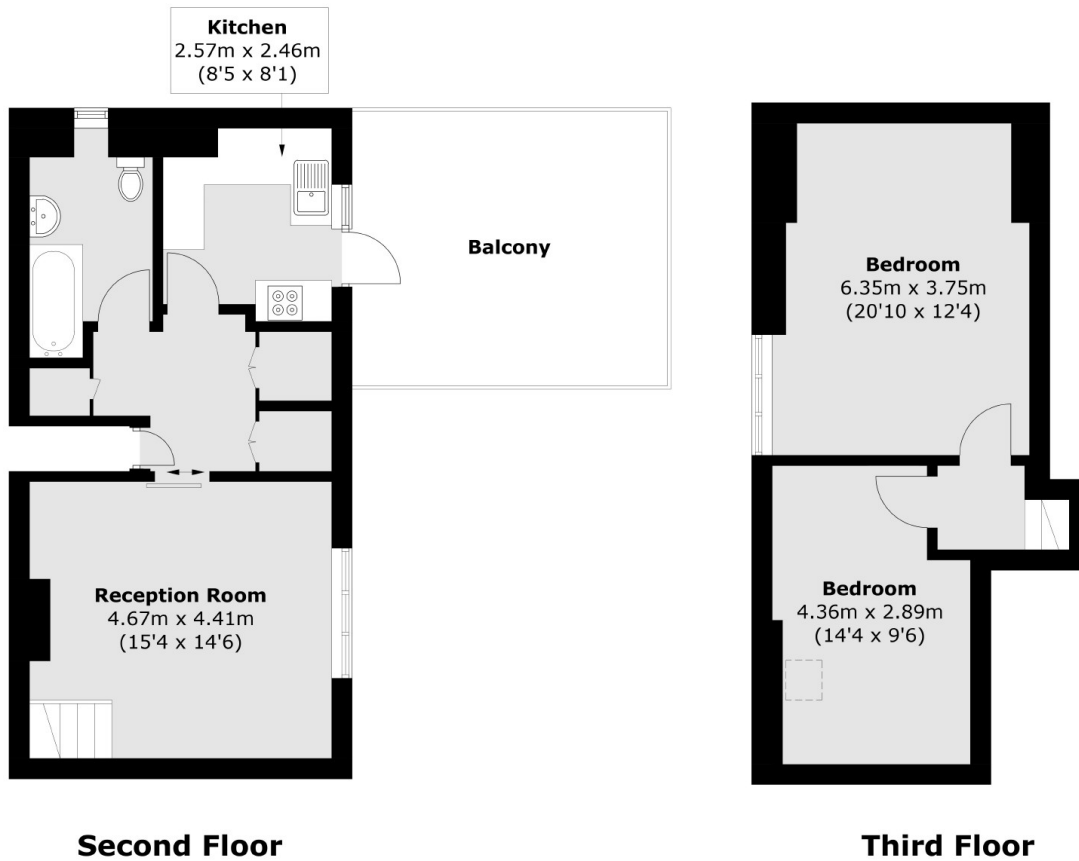

Total area (approx.): 69.6 sq. m (749.2 sq. ft)
Balcony area : 18.4 sq. m (198.0 sq. ft)