



Barmouth Avenue, UB6

£575,000

A great example of a three bedroom semi-detached family home within the popular residential Medway area. The property would benefit from both ground floor and loft extensions. There is shared vehicular access with next door, along with potential to create off street parking. Externally there is a large West facing garden.

Located less than half a mile from Perivale station with Central line tube into and across London. Easy vehicular access with the A40 into and out of London and there are also well regarded local schools.

Features

- Three Bedrooms
- Extension Potential
- West Facing Garden
- Modernisation Required
- Residential Area
- No Onward Chain

Barmouth Avenue, Greenford, UB6

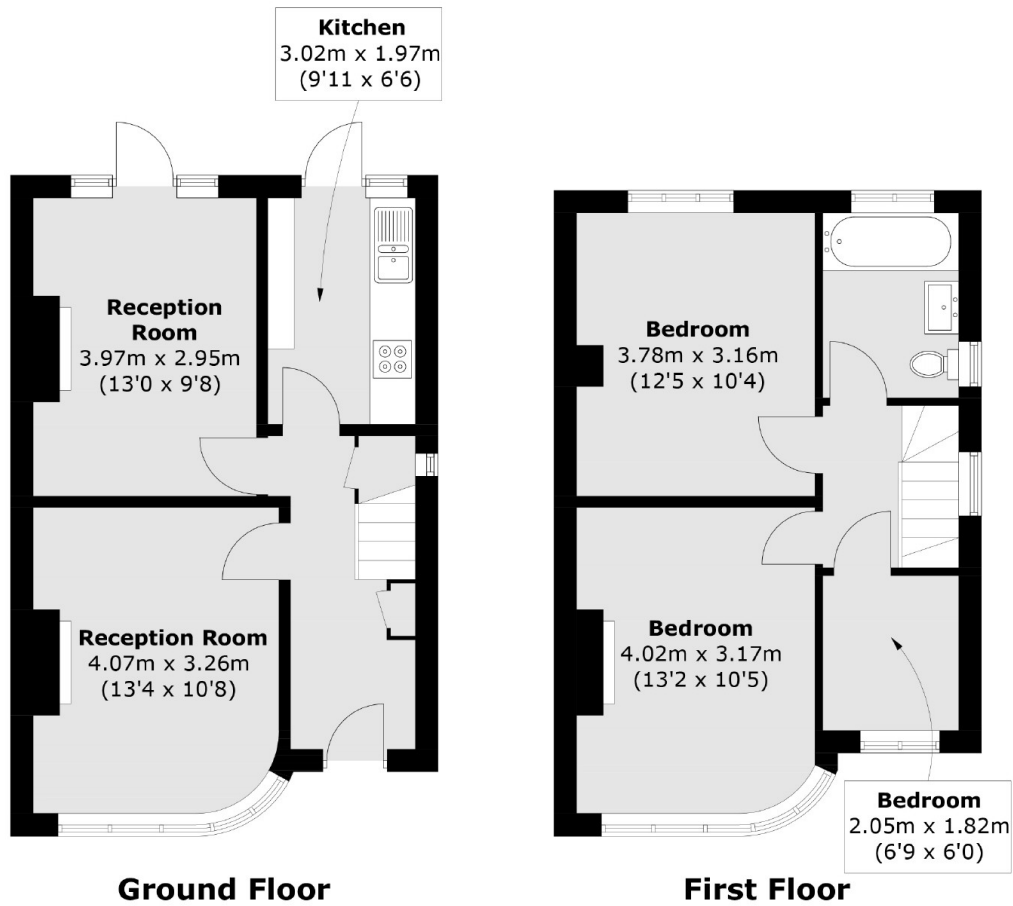

Total area (approx.): 77.6 sq. m (835.2 sq. ft)