

Pinewood Grove, W5

£495,000

A two double bedroom apartment on the second floor, recently refurbished, with floor to ceiling windows offering excellent natural light and open views over playing fields. In excellent condition the property has no onward chain and the benefit of an allocated parking space, and visitor permit.

Pinewood Grove is a quiet, private development, less than half a mile from Ealing Broadway station, with the wide range of shops and amenities that Ealing has to offer just around the corner. It's a short walk to the open space of Haven Green and excellent local schools.

Features

- Two Bedrooms
- Second Floor
- Allocated Parking Space
- No Onward Chain
- Share Of Freehold
- Close To Transport

Pinewood Grove, London, W5

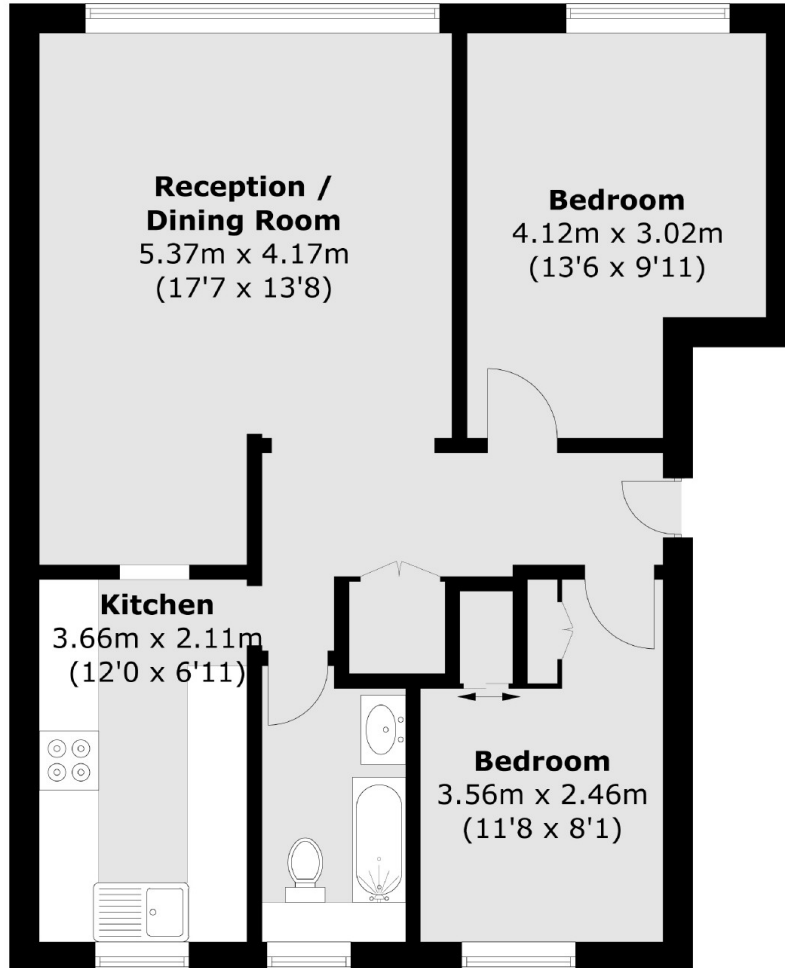

Total area (approx.): 60.8 sq. m (654.4 sq. ft)