



## Langham Gardens, W13

### £425,000

O.I.E.O. A two double bedroom and two bathroom first floor purpose built apartment set within a popular development. Located on the first floor the property comes with a separate garage and a share of the freehold. No onward chain.

Langham Gardens is conveniently located between both Ealing Broadway and West Ealing stations with the new Elizabeth Line, Central and District tube lines, and National Rail services.

### Features

- Two Bedrooms
- Two Bathrooms
- Share Of Freehold
- Garage
- No Onward Chain
- Close To Transport

# Langham Gardens, London, W13

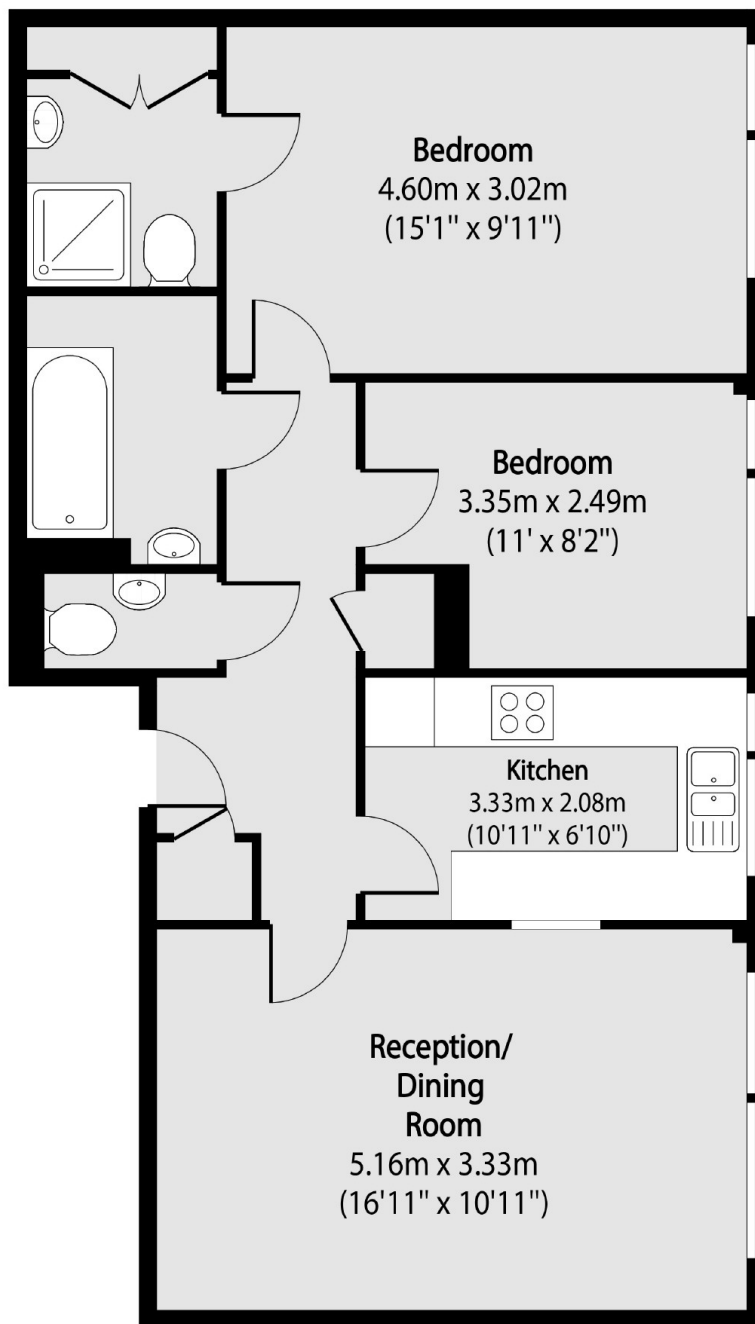

Total area (approx): 64.75 sq m (697 sq. ft)