



## The Grove, W5 £500,000

Located to the rear of a wonderful period building is this ground floor two bedroom maisonette. Newly modernised, the property has allocated parking to the front and direct access to a South facing private garden.

The Grove is a no through road, quiet from traffic, but in the centre of Ealing. The shopping centre, restaurants, gym and all manner of facilities are just over the road and the station is approximately half a mile. Ideally located for Elizabeth, Central, District and Piccadilly lines.

### Features

- Maisonette
- Allocated Parking
- Private Garden
- Long Leasehold
- New Conversion
- No Onward Chain

# The Grove, London, W5

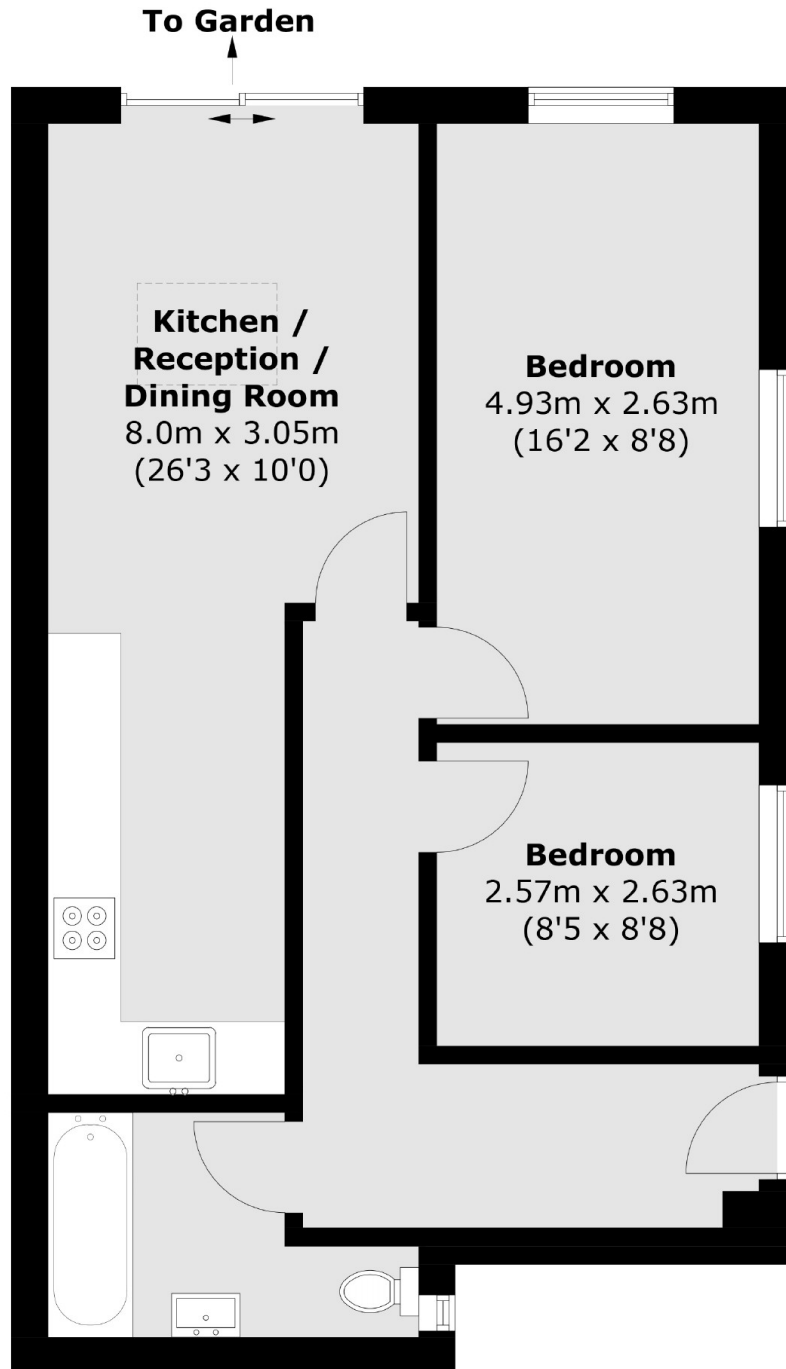

Total area (approx.): 55.0 sq. m (592.0 sq. ft)

## Dexters

Ealing  
2 New Ealing Broadway  
London  
W5 2NU  
Sales  
020 8810 0909

Energy Rating: C. We aim to make our particulars both accurate and reliable. However they are not guaranteed; nor do they form part of an offer or contract. If you require clarification on any points then please contact us, especially if you're traveling some distance to view. Please note that appliances and heating systems have not been tested and therefore no warranties can be given as to their good working order.

 **RICS** | Regulated  
Estate Agent  
and Letting Agent

[dexters.co.uk](https://www.dexters.co.uk)