



Sherborne Gardens, W13

£1,295,000

Dexters



Sherborne Gardens, W13

This five bedroom and three bathroom semi-detached Edwardian family home spanning three floors provides versatile living accommodation for a growing family with over 2000sq.ft of living space.

Currently configured with potential to be used as two self contained apartments with a ground floor two bedroom flat with garden and a split level three bedroom apartment over the first and second floors.

Currently on one title, with minor work, the property is configurable back to a five bedroom and three bathroom family home with two/three reception rooms on the ground floor, leading onto the rear garden. To the front of the property there is off street parking for multiple vehicles.

Located in the popular St. Stephens area there is easy access to both Ealing Broadway and West Ealing stations with multiple transport options. There are many excellent local schools in the immediate area, including the sought after Notting Hill & Ealing Girls.

Features

- Five Bedrooms
- Three Bathrooms
- Edwardian Home
- Period Features
- Over 2000sq.ft
- No Onward Chain







Sherborne Gardens, London, W13

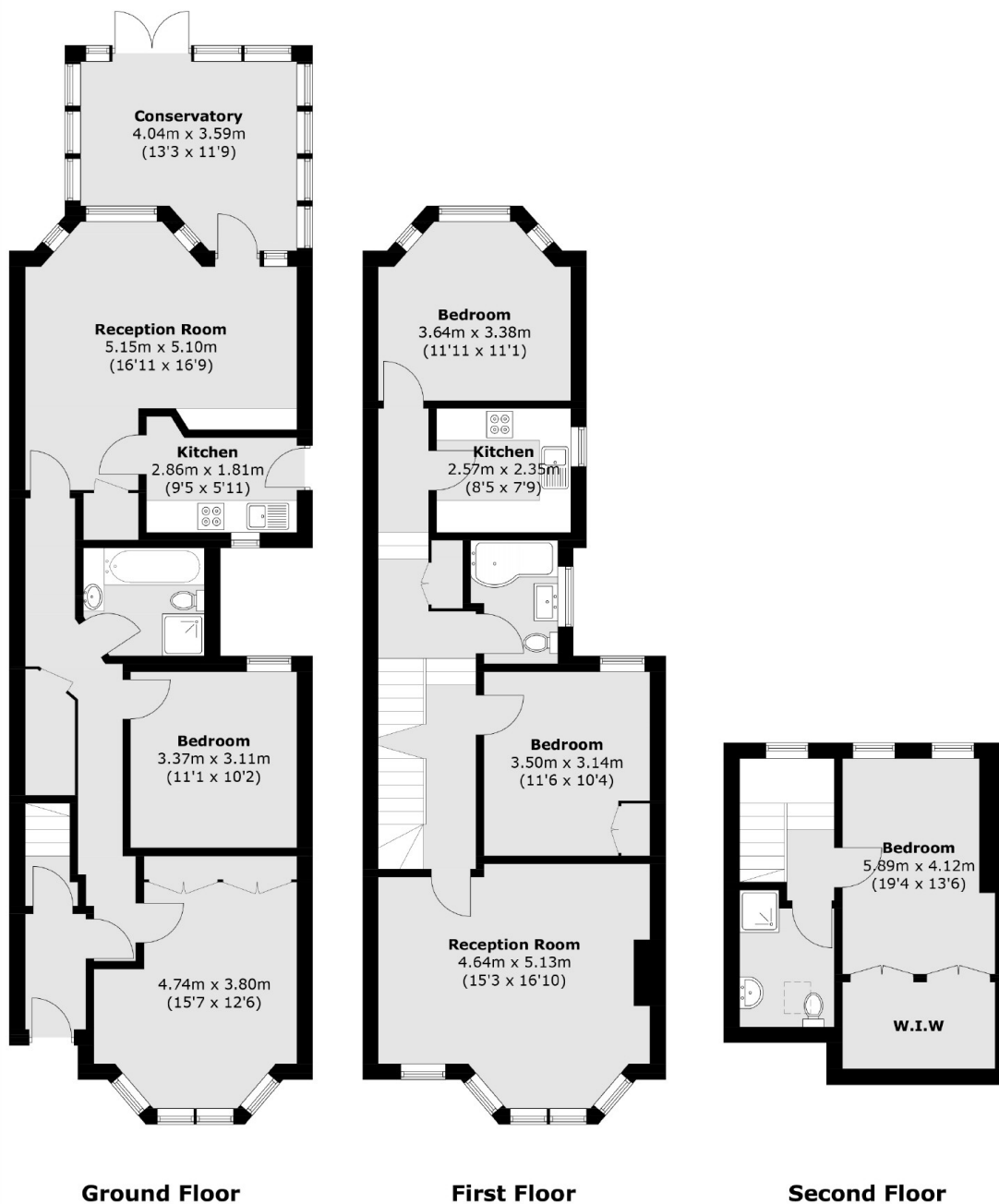

Total area (approx.): 188.0 sq. m (2023.5 sq. ft)