



## Chiswick Quay, W4

£700 Per week

**Dexters**



## Chiswick Quay, London, W4

A four bedroom house located within a tranquil development of town houses surrounding a marina on the River Thames with a private driveway and a roof terrace with river views.

The house is arranged over four floors with a garage at ground floor level which is divided into three parts with a utility room and storage area making it ideal space for an in-house gym.

The split-level reception room on the first floor has views across the garden and into the marina and leads to an eat-in kitchen with it's own river view.

There are four double bedrooms. The master has it's own dressing room, en suite shower room and private roof terrace which has the best view in the house.

Close to transport links with Chiswick mainline station under a quarter of a mile away and there is also access to the A4/M4 motorways.

### Features

- Town House
- Marina Views
- Four Bedrooms
- Garage
- Off-Street Parking
- Roof Terrace











# Chiswick Quay, London, W4



3rd Floor

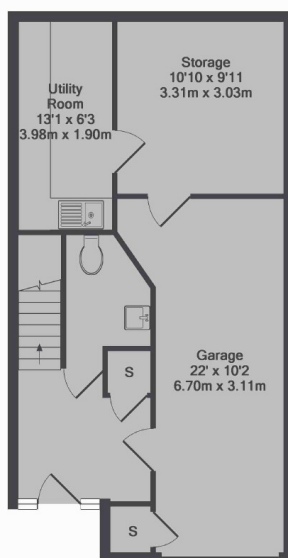

Ground Floor

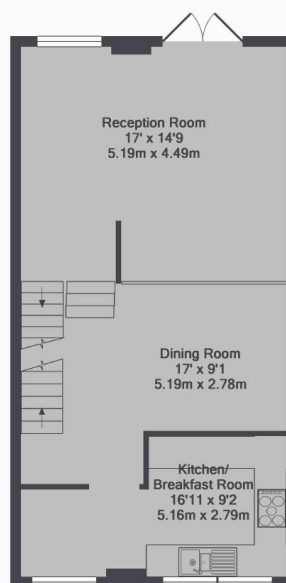

1st Floor

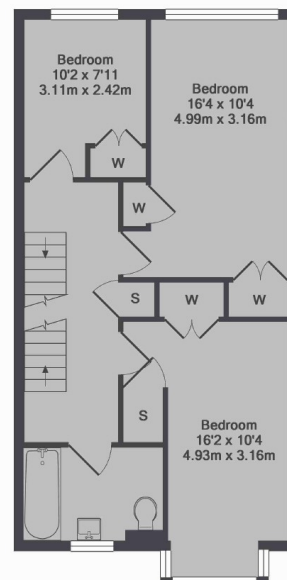

2nd Floor

Chiswick Quay, W4  
Total Approx. Floor Area 2058 Sq. Ft. (191.1 Sq.M.)

**Dexters**

Chiswick  
388 Chiswick High Road,  
Chiswick, London, W4 5TF

Lettings  
020 8995 5439

Energy Rating: D. We aim to make our particulars both accurate and reliable. However they are not guaranteed; nor do they form part of an offer or contract. If you require clarification on any points then please contact us, especially if you're traveling some distance to view. Please note that appliances and heating systems have not been tested and therefore no warranties can be given as to their good working order.

**RICS** Regulated  
Estate Agent  
and Letting Agent

[dexters.co.uk](http://dexters.co.uk)