



## Bourne Place, W4

£425,000

A well-presented one bedroom apartment overlooking Chiswick High Road, situated on the second floor of this sought-after purpose built block. With allocated underground parking, share of freehold, bike storage and offered with no onward chain.

Chatsworth Lodge is centrally located on Chiswick High Road with immediate access to all the shops, cafés, restaurants and transport links it has to offer. Turnham Green and Chiswick Park stations are within easy walking distance.

### Features

- One Double Bedroom
- Underground Parking
- Share Of Freehold
- Lift Access
- Central Location
- No Onward Chain

Bourne Place,  
London, W4

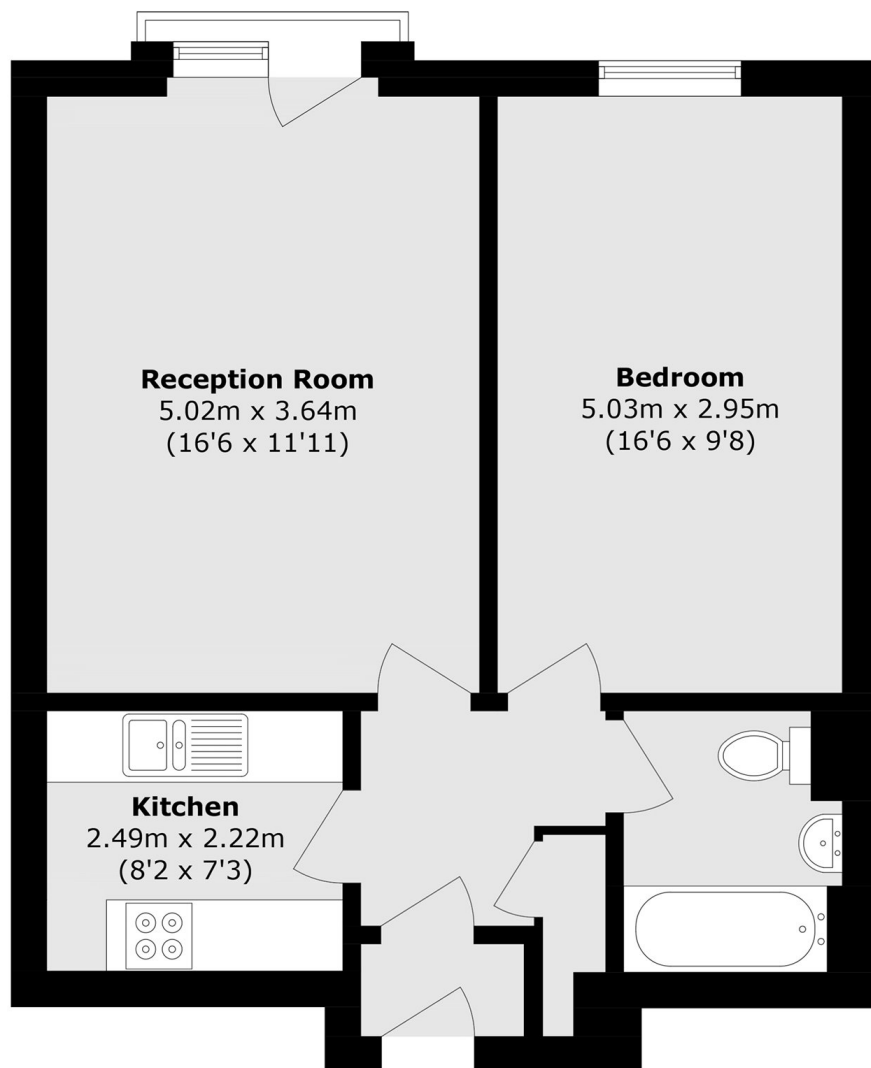

Total area (approx.): 50.6 sq. m (544.6 sq. ft)