



Chiswick High Road, W4

£700,000

A well presented second floor two double bedroom, two bathroom apartment within this popular development. With modern finish, two south-facing balconies, lift access, allocated parking and offered with no onward chain.

Chiswick High Road offers a brilliant array of shops, restaurants and cafés to choose from, as well as being serviced by Gunnersbury and Chiswick Park stations. The Thames riverside and Chiswick House and grounds are popular spots nearby.

Features

- Two Double Bedrooms
- Two Bathrooms
- Two Balconies
- Lift Access
- Allocated Underground Parking
- No Onward Chain

Chiswick High Road, London, W4

Chiswick High Road, W4

Approx. Gross Internal Area :-
93 sq m / 1001 sq ft

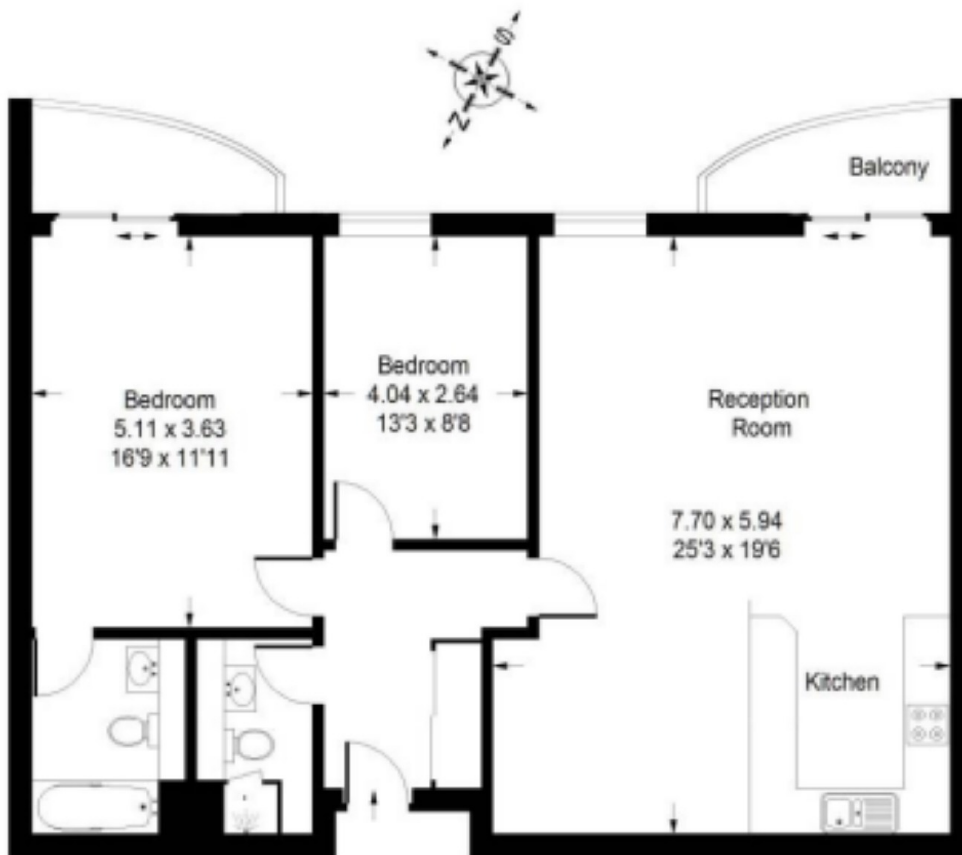

Second Floor

Dexters

Chiswick
388 Chiswick High Road
London
W4 5TF
Sales
020 8995 4321

Energy Rating: C. We aim to make our particulars both accurate and reliable. However they are not guaranteed; nor do they form part of an offer or contract. If you require clarification on any points then please contact us, especially if you're traveling some distance to view. Please note that appliances and heating systems have not been tested and therefore no warranties can be given as to their good working order.

 **RICS** | Regulated
Estate Agent
and Letting Agent

[dexters.co.uk](https://www.dexters.co.uk)