



Paddlers Avenue, TW8

£540,000

A bright and modern two double bedroom, sixth floor apartment within the highly sought after Brentford Lock West development. With long lease, lift access, private balcony and allocated underground parking.

Isambard Court is located in the award winning Brentford Lock West development. It is half a mile to the main square of Brentford High Street and Brentford station. There are also bus routes that stop close to the apartment to make a short journey to Piccadilly line stations.

Features

- Sixth Floor
- Two Double Bedrooms
- Lift Access
- Private Balcony
- Allocated Underground Parking
- Award Winning Development

Paddlers Avenue, Brentford, TW8

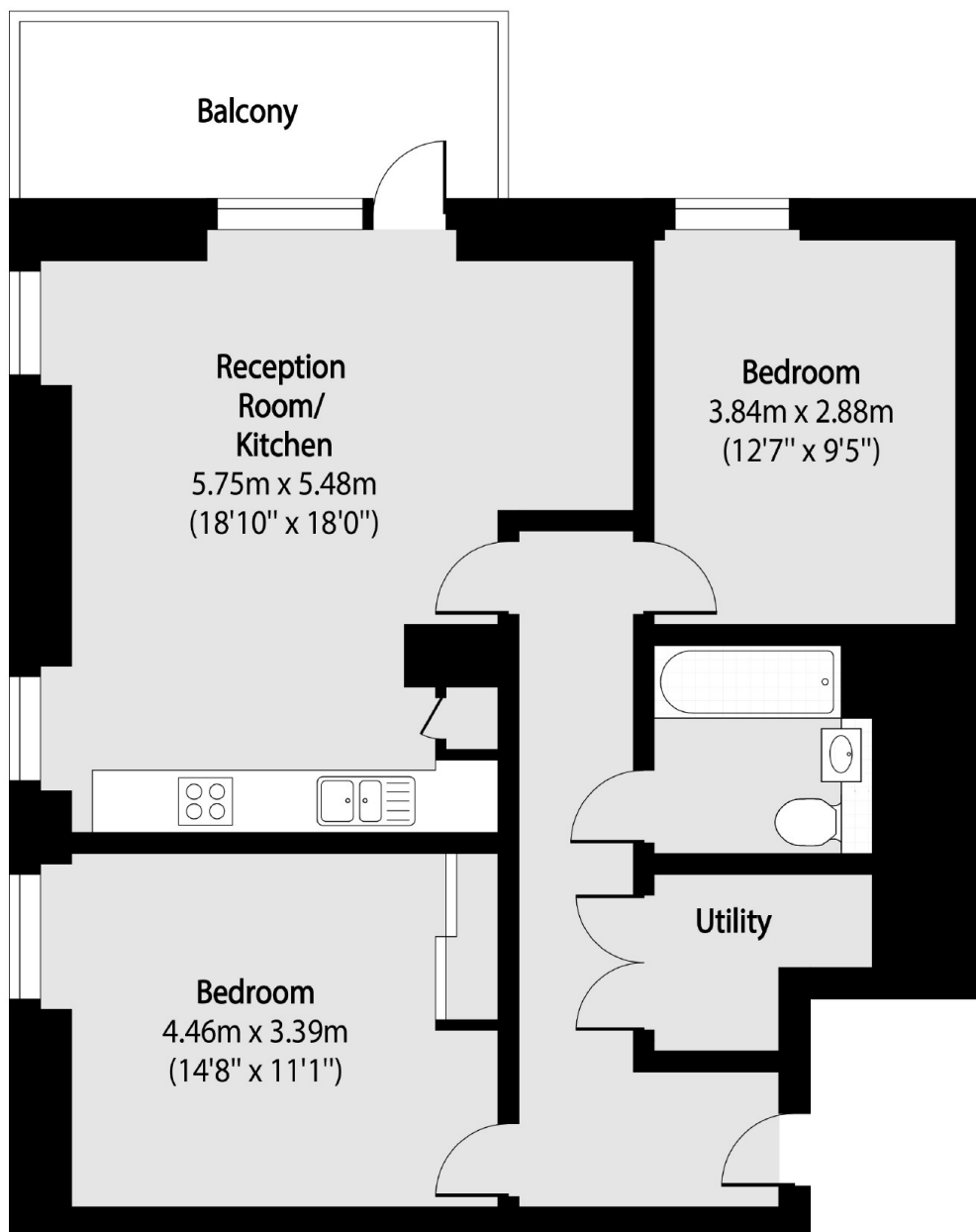

Total area (approx): 73.10 sq m (787 sq. ft)

Balcony total area (approx): 7.82 sq m (84 sq. ft)

Dexters

Chiswick
388 Chiswick High Road
London
W4 5TF
Sales
020 8995 4321

Energy Rating: . We aim to make our particulars both accurate and reliable. However they are not guaranteed; nor do they form part of an offer or contract. If you require clarification on any points then please contact us, especially if you're traveling some distance to view. Please note that appliances and heating systems have not been tested and therefore no warranties can be given as to their good working order.

 **RICS** | Regulated
Estate Agent
and Letting Agent

dexters.co.uk