



Church Path, W4

£450,000

A larger than average, well presented two double bedroom first floor flat. The property is in modern decorative order and offered with no onward chain - perfect as a first-time buy or investment.

Church Path is located within half a mile of Chiswick Park and South Acton underground stations. The property is also close to local amenities and bus links on Acton Lane and Chiswick High Road.

Features

- Two Double Bedrooms
- First Floor
- Purpose Built
- External Storage Unit
- Modern
- No Onward Chain

Church Path,
London, W4

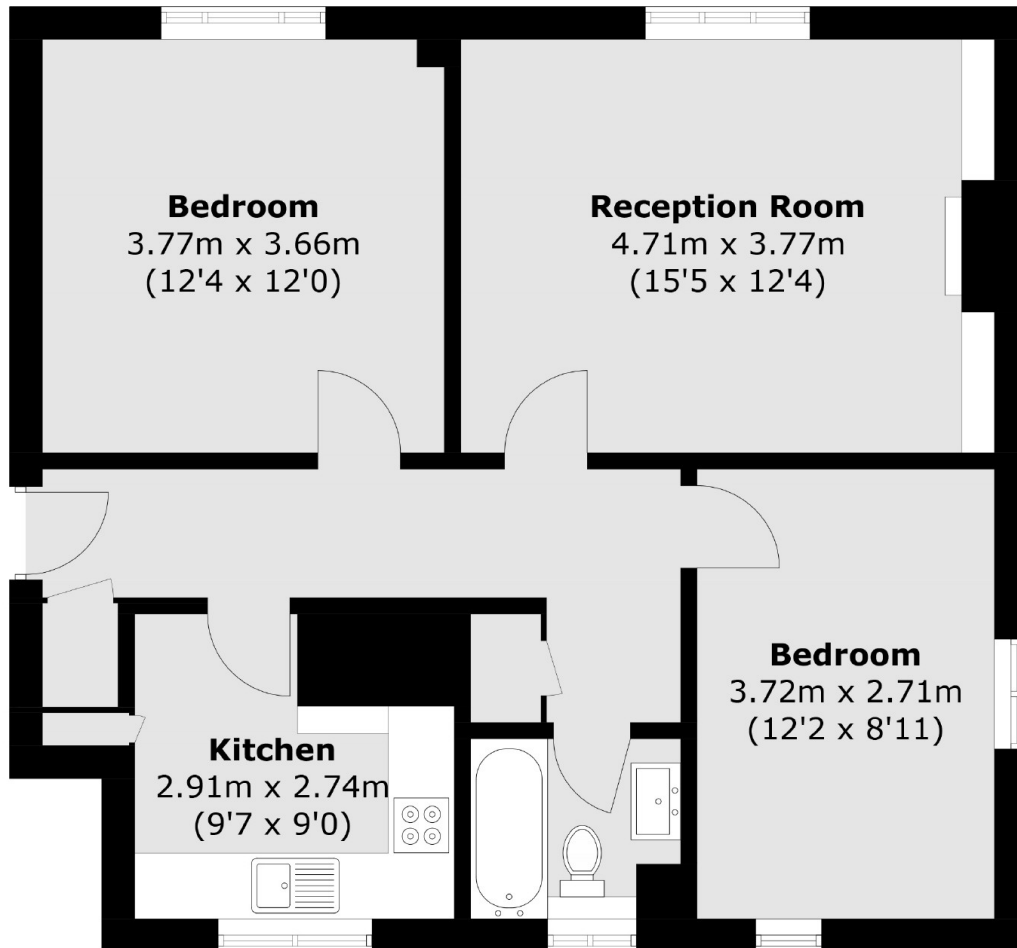

Total area (approx.): 68.3 sq. m (735.2 sq. ft)

Dexters

Chiswick
388 Chiswick High Road
London
W4 5TF
Sales
020 8995 4321

Energy Rating: C. We aim to make our particulars both accurate and reliable. However they are not guaranteed; nor do they form part of an offer or contract. If you require clarification on any points then please contact us, especially if you're traveling some distance to view. Please note that appliances and heating systems have not been tested and therefore no warranties can be given as to their good working order.

 **RICS** | Regulated
Estate Agent
and Letting Agent

[dexters.co.uk](https://www.dexters.co.uk)