



Chiswick Road, W4

£260,000

A second floor, one bedroom flat within this centrally located development. With open-plan living/kitchen, long lease and offered with no onward chain.

Chiswick Road runs parallel to Chiswick High Road and is ideally located for all of its amenities as well as Chiswick Park station and Chiswick Business Park.

Features

One Bedroom
Purpose-Built
Second Floor
Long Lease
Close To Transport
No Onward Chain

Chiswick Road,
London, W4

Second Floor

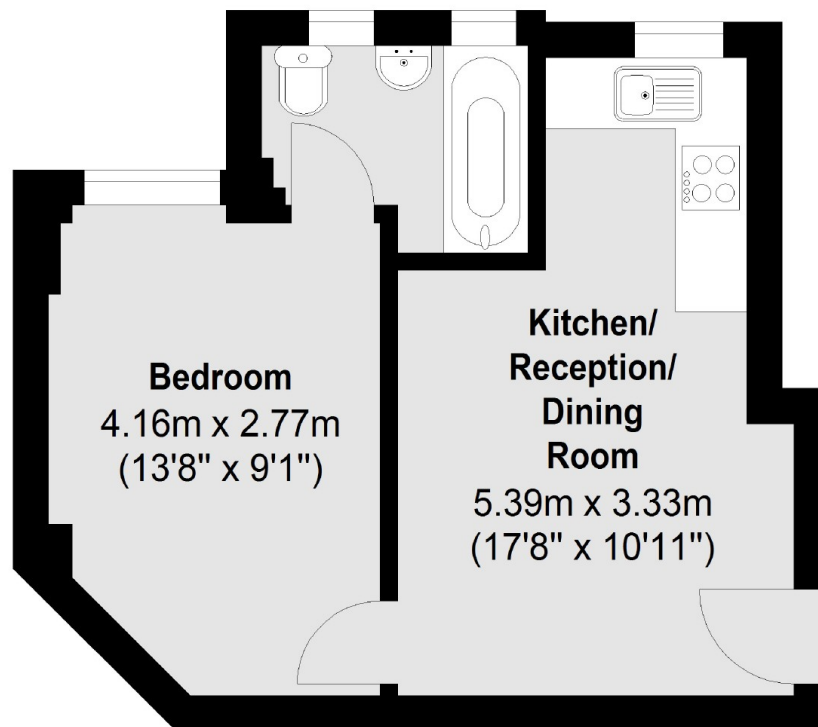

Internal Area (approx.): 29.8 sq. m (320.8 sq. ft)