



Chiswick Village, W4 £435,000

OFFERS IN EXCESS OF

A recently refurbished, immaculately presented two double bedroom, top floor apartment within this highly sought-after development. With share of freehold, lift access and well maintained communal grounds.

Chiswick Village is within half a mile of Gunnersbury Station (District & Overground), Kew Bridge Station (GWR) and the M4/A4 providing excellent access into and out of London. Highly regarded schools such as Strand on the Green, local amenities, restaurants and the River Thames are also close by.

Features

- Top Floor
- Two Double Bedrooms
- Lift Access
- Share Of Freehold
- Communal Gardens
- Close To Transport

Chiswick Village, London, W4

Fourth Floor

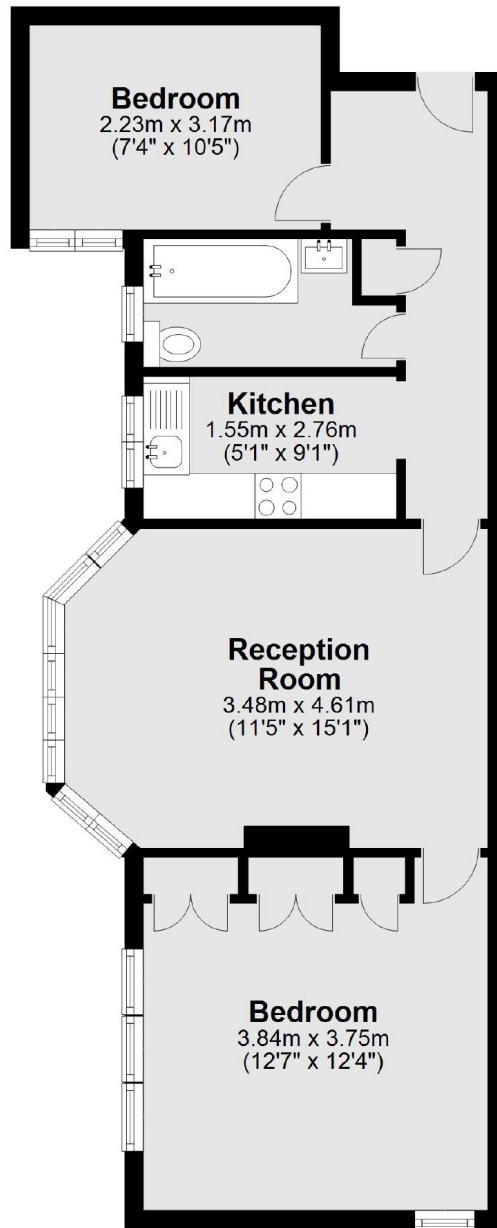

Total area: approx. 52.2 sq. metres (561.8 sq. feet)