



Chiswick Village, W4

£507 Per week

This ground floor apartment has been refurbished to a high standard with an open plan reception room with a modern kitchen, a large master bedroom with built-in wardrobes and a further single bedroom.

Chiswick Village is within half a mile of Kew Bridge and Gunnersbury stations which along with the M4/A4 offers excellent access in and out of town.

Features

- Ground Floor
- Open Plan
- Two Bedrooms
- Recently Refurbished
- Wood Flooring
- Heating/Hot Water Inc

Chiswick Village, London, W4

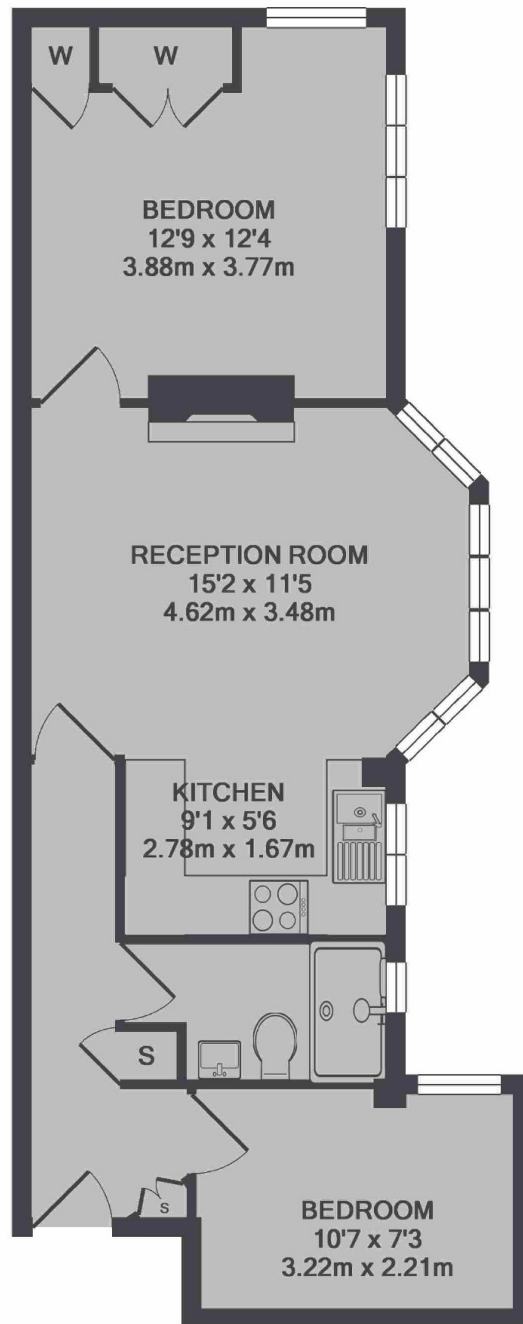

TOTAL APPROX. FLOOR AREA 573 SQ.FT. (53.3 SQ.M.)