



Silver Crescent, W4

£425,000

A very well presented two bedroom apartment which is a stone throw away from local transport and Chiswick business park. The property has two double bedrooms, one recently renovated bathroom, a large dual aspect living room and a high specification kitchen.

Silver Crescent is located within a minutes walk to Gunnersbury Underground Station (District & Overground) as well as local bus links towards the shops and restaurants of Chiswick High Road. Kew Bridge Station is also near by providing fast access to central London. Local schools, green spaces and the river are also close.

Features

- Central Location
- Purpose Build Apartment
- High Level Specification
- Close To Transport
- Second Floor Apartment
- Lift Access

Silver Crescent,
London, W4

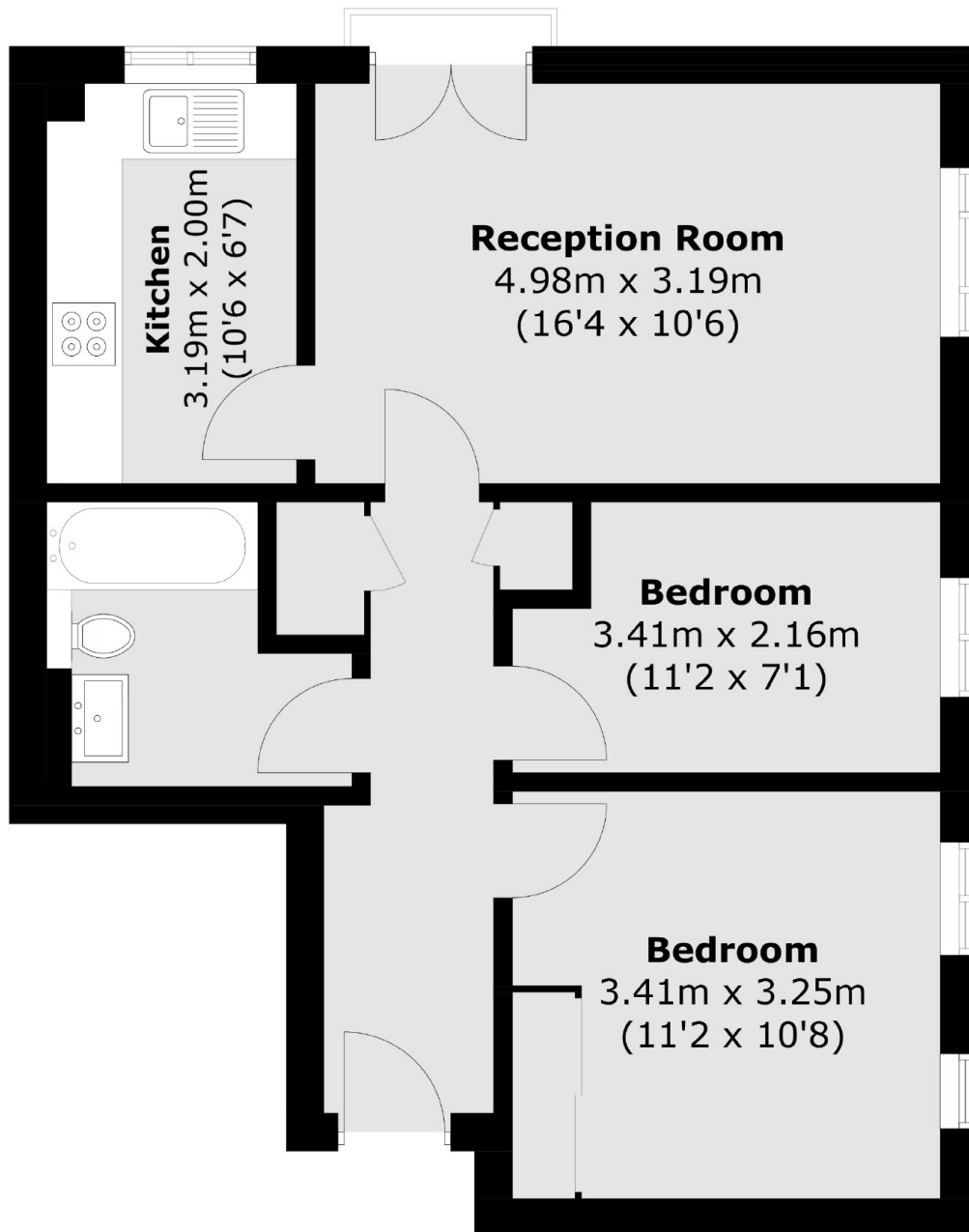

Total area (approx.): 55.4 sq. m (596.3 sq. ft)