



Heathfield Terrace, W4

£426 Per week

On the fourth floor of this well-located mansion block in the heart of Chiswick is this bright and spacious one bedroom apartment. The property has ample storage throughout, parking available and the further benefit of heating and hot water included in the rent.

Located a quarter of a mile from Chiswick Park station, and just over half a mile to Turnham Green and Gunnersbury stations, offering fantastic transport links. It is also very close to an array of shops, cafés, restaurants and further amenities along Chiswick High Road.

Features

- Ground Floor
- Mansion Block
- One Bedroom
- Neutral Decor
- Parking Available
- Heating & Hot Water Included

Heathfield Terrace,
London, W4

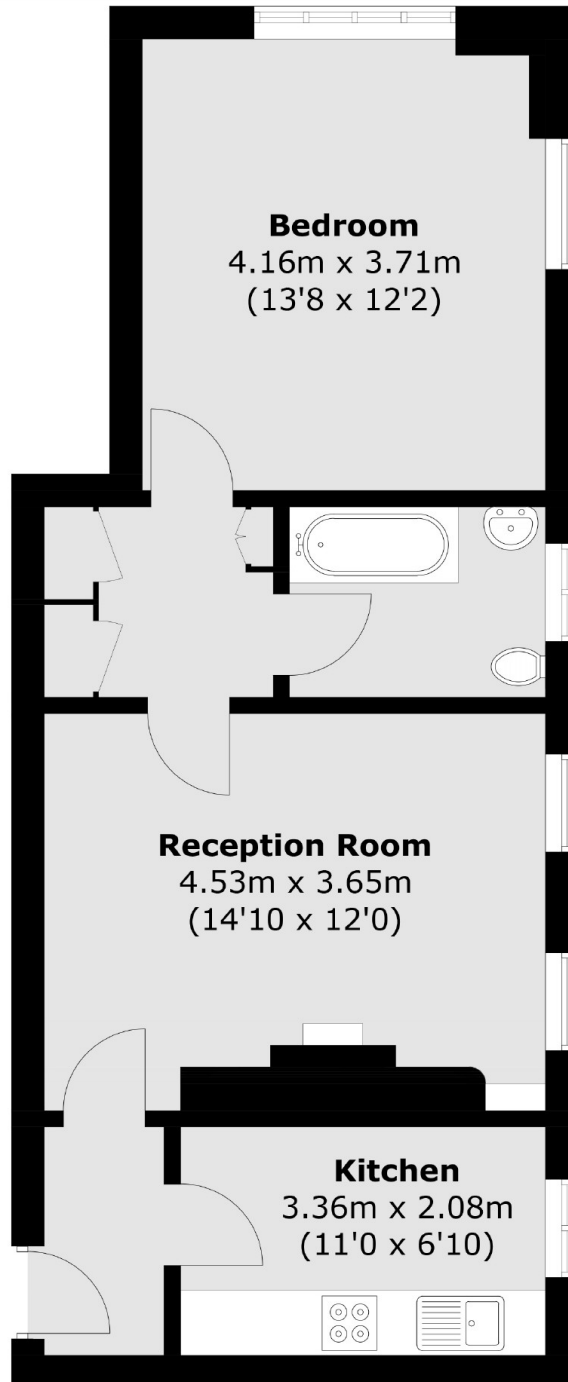

Total area (approx.): 51.9 sq. m (558.6 sq. ft)