



Colonial Drive, W4 £650,000

Offered with no onward chain is this modern two bedroom, two bathroom apartment situated in the heart of Chiswick. The property is in excellent condition throughout and comes with a private balcony, lift and a concierge.

Colonial Drive is located within half a mile from Chiswick Park tube station and the amenities on Chiswick High Street. The property also falls within the outstanding Belmont School catchment.

Features

- Two Bedrooms
- Two Bathrooms
- Private Balcony
- Concierge Service
- Popular Development
- Central Location

Colonial Drive,
London, W4

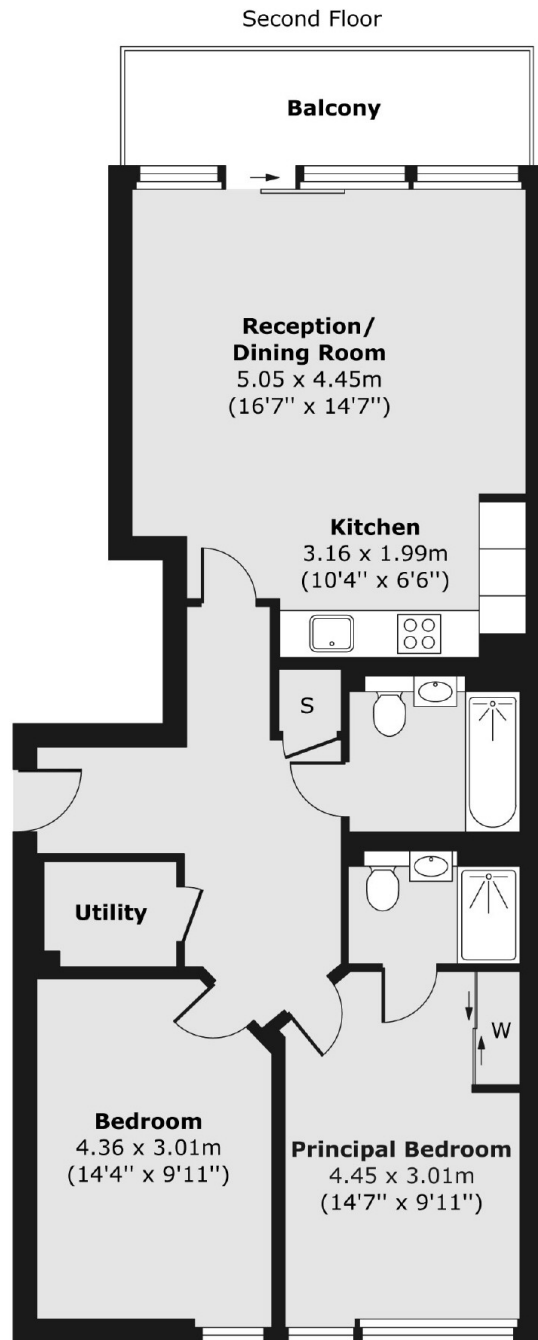

Total area (approx.) 79.70 sq. m (858 sq. ft)
Balcony area (approx.) 7.68 sq. m (83 sq. ft)