



Trinity Way, W3

£250,000

A ground floor apartment with two double bedrooms, ideal for living or investment. This ex-local authority flat has a separate kitchen and WC, maximising convenience and privacy. With approximately 800 sq.ft of space, it's a perfect blend of comfort and practicality.

Less than ten minutes walk from East Acton station (Central line) and under a mile from Acton Main Line station (Elizabeth line) and Acton Central station (Overground).

Features

- Ground Floor Flat
- Two Double Bedrooms
- Ex-Local Authority
- No Onward Chain
- Circa 800 sq.ft
- Low Service Charge

Trinity Way,
London, W3

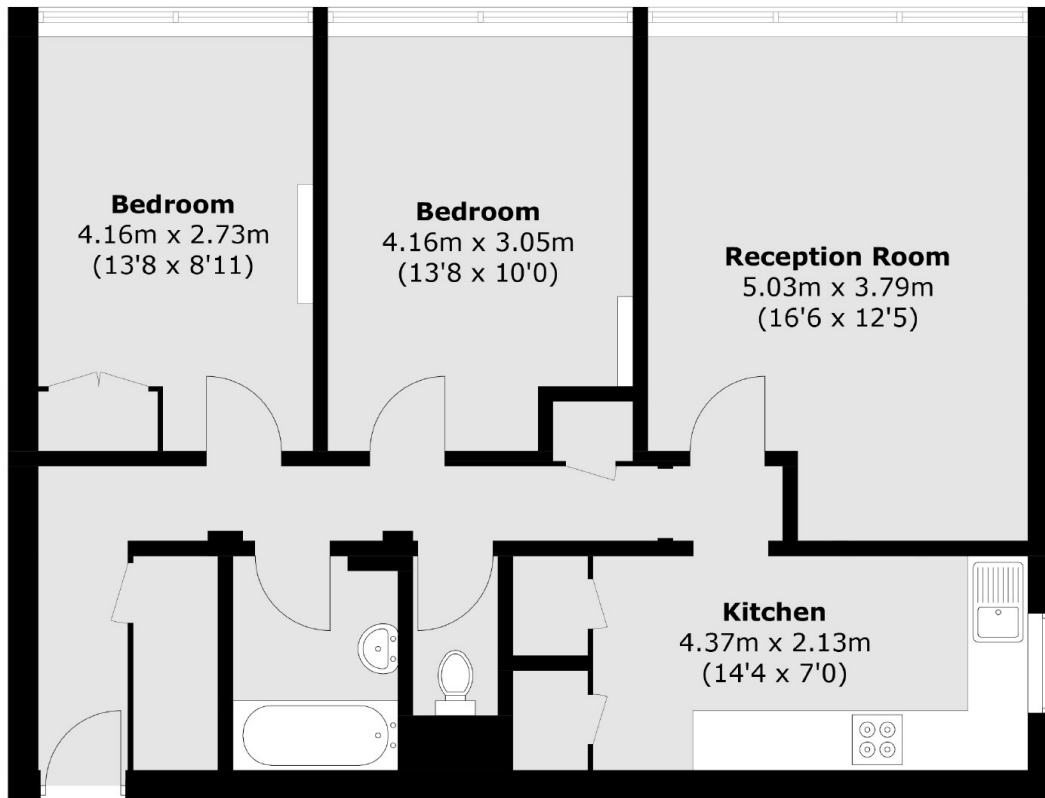

Total area (approx.): 72.9 sq. m (784.7 sq. ft)