

Lynton Road, W3

£450,000

A purpose built three bedroom purpose built apartment moments from the new Elizabeth Line station, Acton Main Line. This well maintained property has allocated off-street parking and a share of the freehold.

Lynton Road is within 500 metres of Acton Main Line and half a mile from West Acton station both of which provide excellent access into town.

Features

- West Acton
- Share of Freehold
- Three Bedrooms
- Close to Elizabeth Line
- No onward chain
- Low service charges

Lynton Road, London, W3

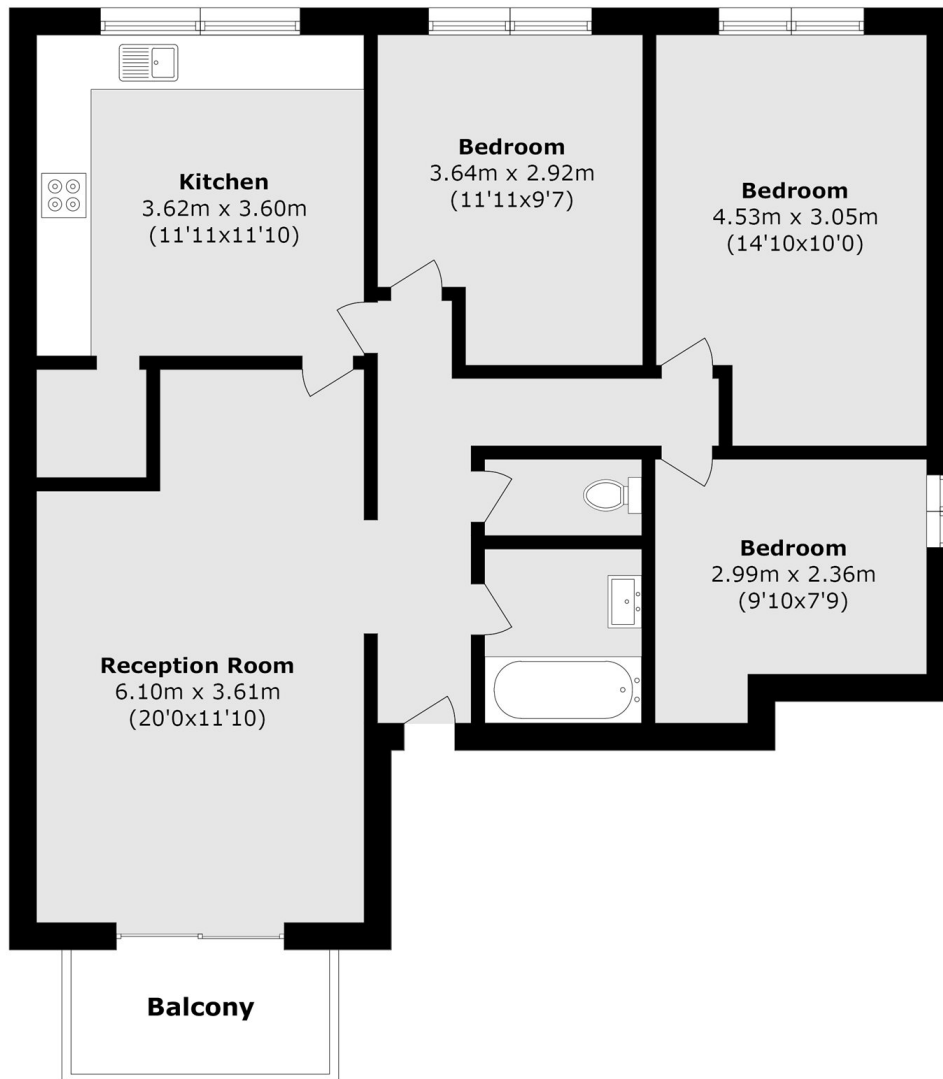

Total area (approx.): 81.3 sq. m (875.1 sq. ft)
(Excluding Balcony)

Balcony area (approx.): 3.9 sq. m (41.9 sq. ft)