



Midland Terrace, NW10

£340,000

A beautifully renovated one-bedroom ground-floor period conversion, filled with natural light and offering direct access to a low-maintenance private garden. The property enjoys a well-balanced layout, featuring a separate modern kitchen, a bright reception room, and a walk-through study area. Ideally situated on Midland Terrace, the home is offered to the market with no onward chain.

There are a range of local amenities moments from the property as well as great transport links at Willesden Junction (Overground) Park Royal (Piccadilly) and North Acton (Central).

Features

- One Bedroom
- Period Conversion
- Modern Finish
- Private Garden
- Good Transport Links
- No Onward Chain

Midland Terrace, London, NW10

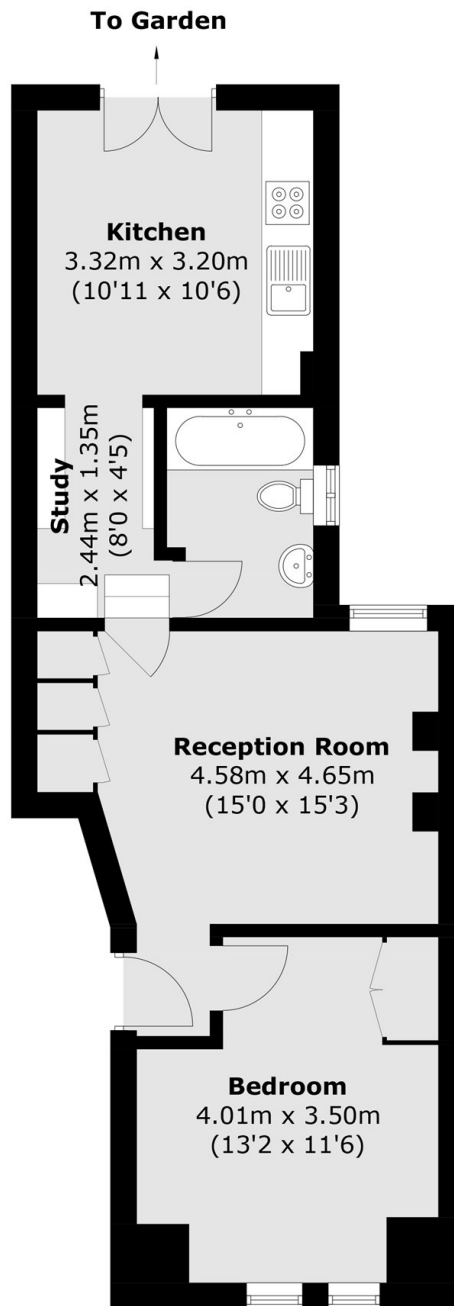

Total area (approx.): 48.6 sq. m (523.1 sq. ft)

Dexters

Acton
171 High Street
London
W3 6LP
Sales
020 8896 2112

Energy Rating: C. We aim to make our particulars both accurate and reliable. However they are not guaranteed; nor do they form part of an offer or contract. If you require clarification on any points then please contact us, especially if you're traveling some distance to view. Please note that appliances and heating systems have not been tested and therefore no warranties can be given as to their good working order.

 **RICS** | Regulated
Estate Agent
and Letting Agent

[dexters.co.uk](https://www.dexters.co.uk)