



Manor Court, W3

£399,950

A well presented two bedroom apartment set within an Art Deco building on the borders of Chiswick. The property is circa 650 sq.ft, has a new kitchen fitted and will be sold with no onward chain.

Located within a 10 minute walk from Chiswick High Street and just over a half mile from Acton Town station (District and Piccadilly Line).

Features

- Two Bedrooms
- Newly Extended Lease
- Art Deco Build
- Allocated Parking
- Chiswick Borders
- Gated Development

Manor Court, London, W3

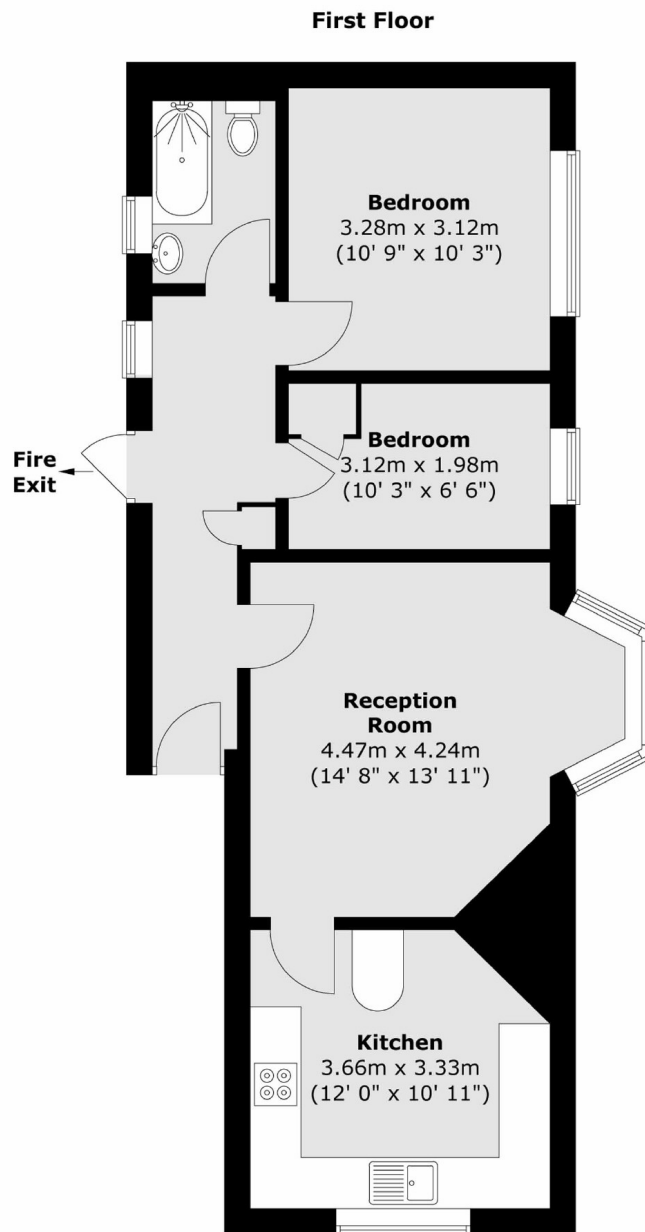

Total area (approx.) : 58.9 sq. m (634 sq. ft)