



Leythe Road, W3

£635,000

This stunning four bedroom split-level apartment with over 1,000 sq.ft of living space, is set within a beautifully converted period building. The property features two modern bathrooms, high ceilings and is in excellent condition throughout. A Juliet balcony adds a charming touch, enhancing the bright and airy ambiance of this exceptional home.

Approximately five minutes walk from South Acton station (Overground) and just over fifteen minutes walk from Acton Town and Chiswick Park tube stations.

Features

- Period Conversion
- Two Bathrooms
- Four Bedrooms
- Long Lease
- Circa 1,050 sq.ft
- Close to Chiswick

Leythe Road,
London, W3

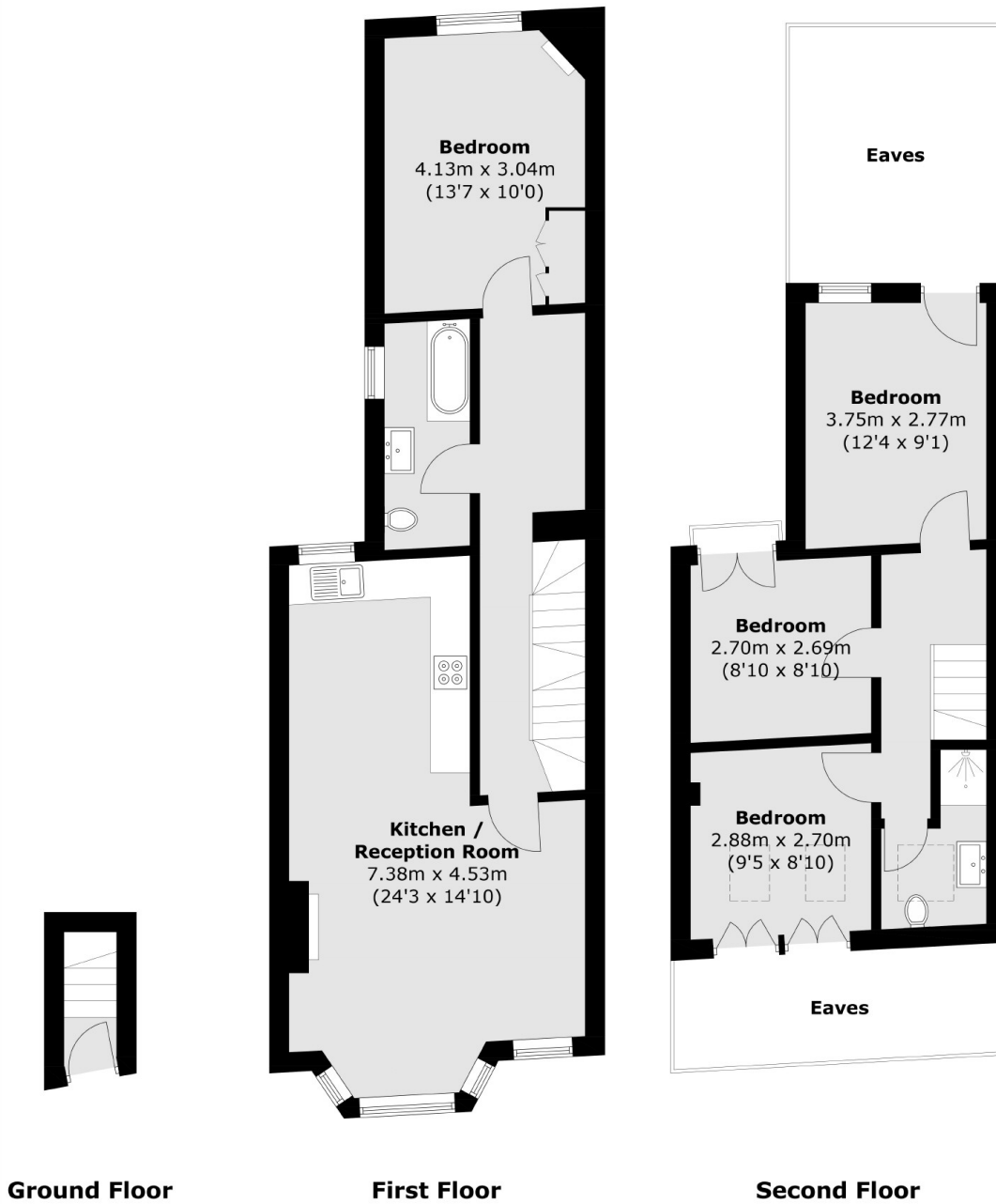

Total area (approx.): 97.6 sq. m (1,050.4 sq. ft)
(Excluding Eaves)