



Bromyard Avenue, W3

£669 Per week

This beautiful top floor penthouse apartment would be suitable for a family looking for space and comfort, it has three double bedrooms, two balconies overlooking London and two bathrooms.

Bromyard House is located just under a mile to east Acton station and less than a mile to Acton central station overground.

Features

- Gated Development
- Beautiful Penthouse
- Spacious Reception Room
- Three Double Bedrooms
- Two Bathrooms
- Concierge

Bromyard Avenue, London, W3

Fifth Floor

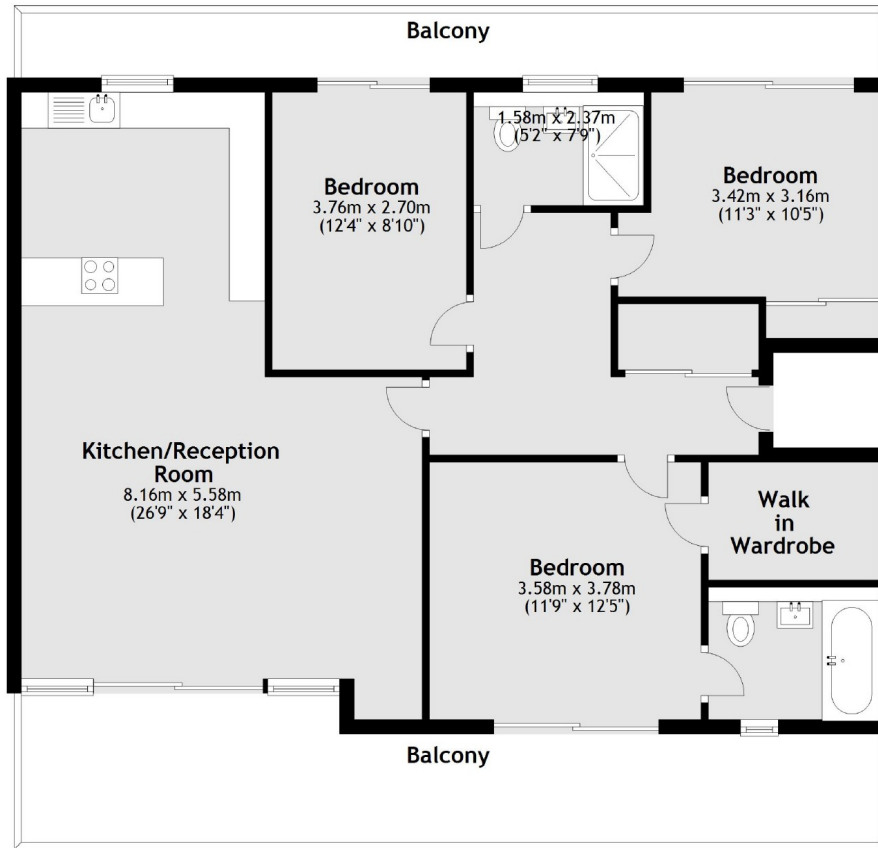

Main area: Approx. 98.6 sq. metres (1061.5 sq. feet)
Plus balconies, approx. 33.7 sq. metres (362.8 sq. feet)