



Lakeside Drive, NW10

£459,000

This two bedroom contemporary apartment has been finished to a high standard throughout and has an abundance of natural light. The apartment has a balcony which overlooks the picturesque landscaped gardens.

Located less than half a mile from Park Royal (Piccadilly line) and Hanger Lane (Central line) tube stations. Lakeside Drive is served by the 226 bus route with direct access to Ealing Broadway.

Features

- Communal Park
- Lift Access
- Two Bathrooms
- Underfloor Heating
- Fitted Wardrobes
- Covered Balcony

Lakeside Drive,
London, NW10

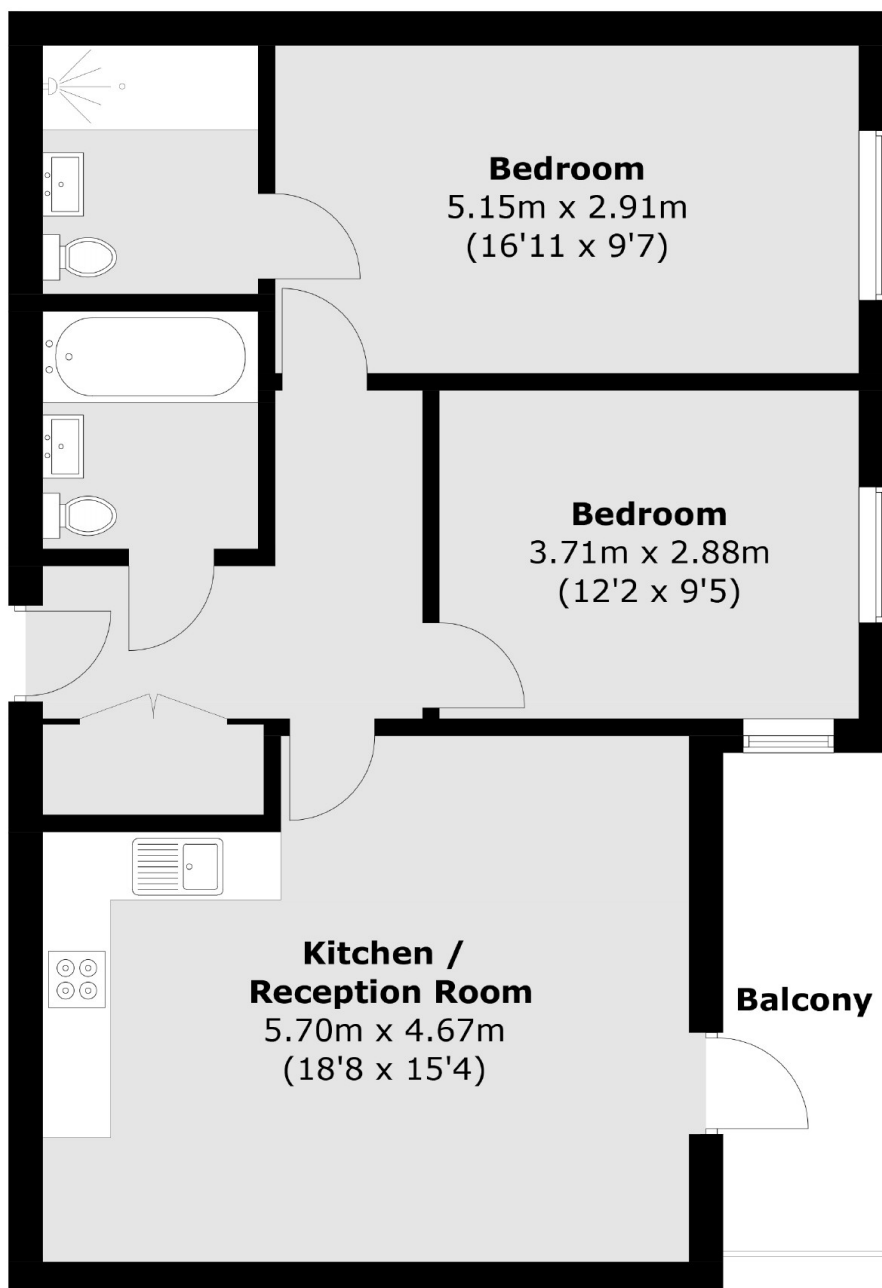

Total area (approx.): 70.4 sq. m (757.8 sq. ft)
Balcony area: 6.4 sq. m (68.9 sq. ft)