



## Bromyard Avenue, W3

£260,000

Situated within the sought-after Bromyard House development is this studio apartment located on the second floor with a west facing aspect. Bromyard House is a gated development with a 24 hour concierge service.

Situated within close proximity to the David Lloyd health and fitness club and several parks. East Acton tube (Central line), Acton Central (Overground) and Acton Main Line (Elizabeth line) stations are all within easy reach.

### Features

- Second Floor
- West Facing Aspect
- Long Lease
- Gated Development
- Good Rental Investment
- 24 Hour Concierge

Bromyard Avenue,  
London, W3

## Second Floor

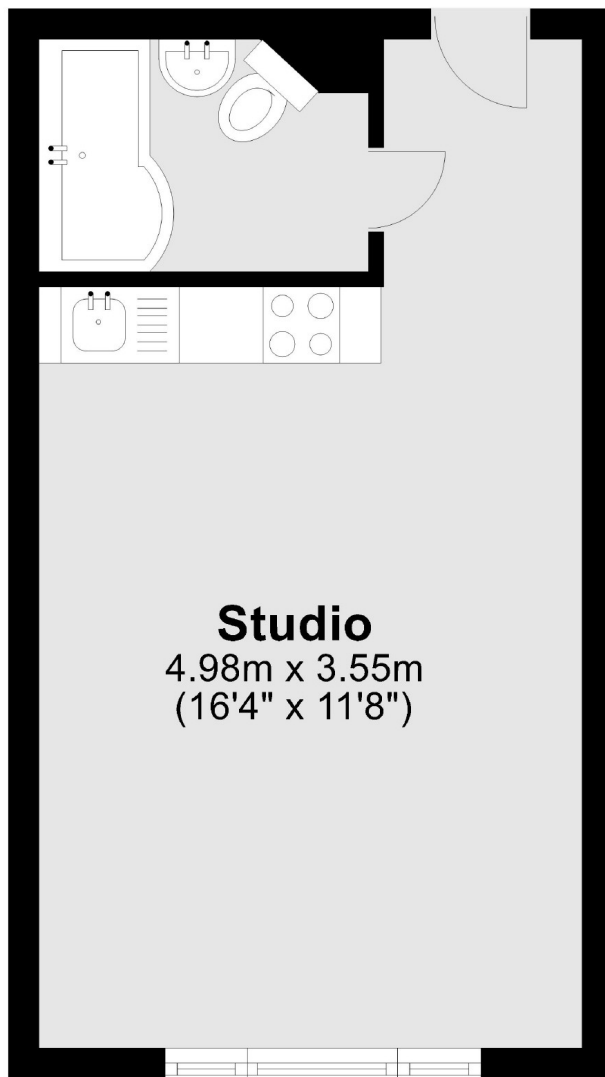

Total area: approx. 23.4 sq. metres (252.2 sq. feet)