



## Rosemont Road, W3

### £349,000

A two double bedroom apartment arranged with just under 700 sq.ft of living space. The flat has a separate eat-in kitchen, access to off-street parking and a long lease.

Rosemont Court is situated directly opposite Springfield Gardens and just over half a mile from Acton Central (Overground) and Acton Main Line (Elizabeth line) stations.

### Features

- Two Bedrooms
- Off-Street Parking
- Lift Access
- Long Lease
- Separate Kitchen
- Double Aspect

Rosemont Road,  
London, W3

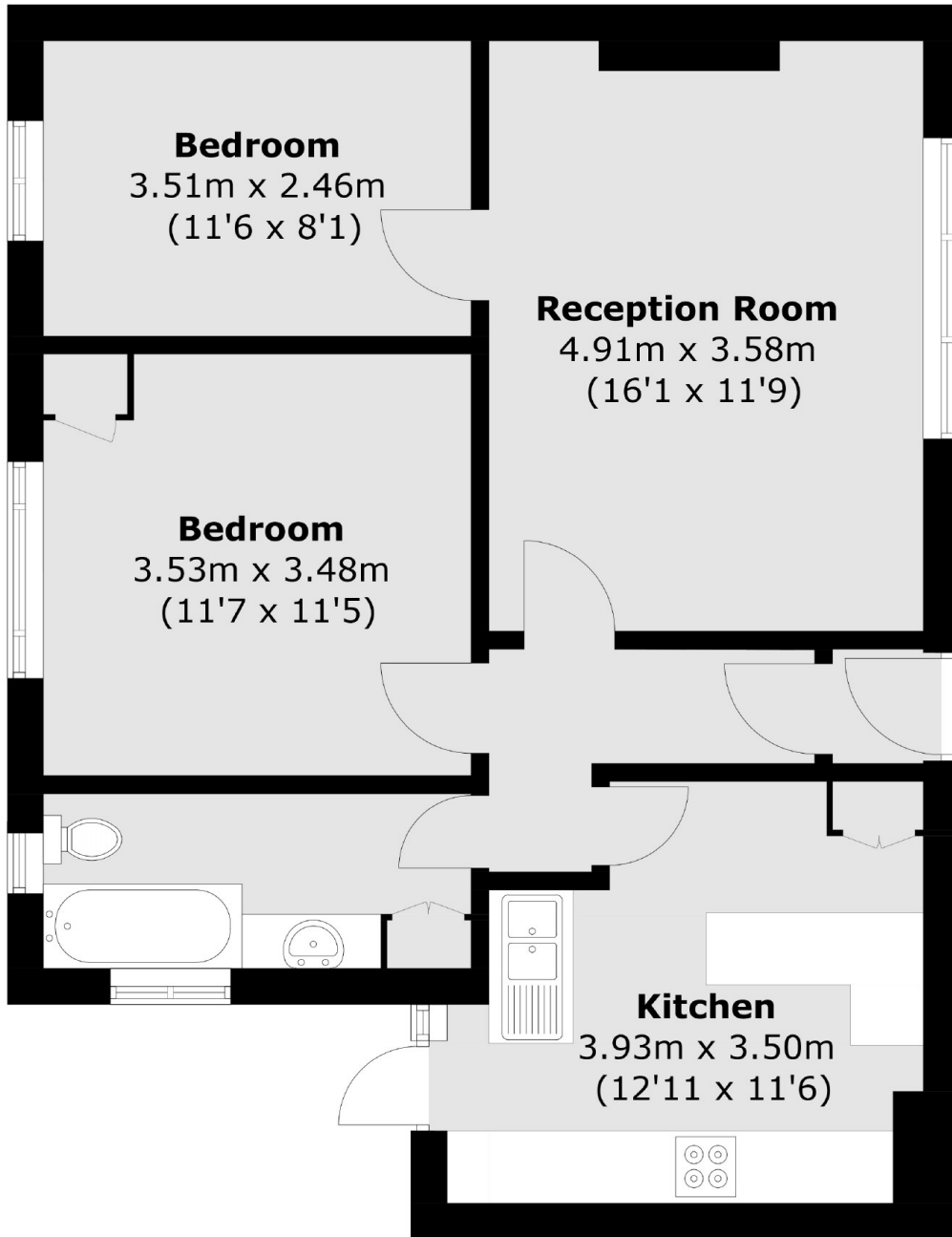

Total area (approx.): 64.1 sq. m (690.0 sq. ft)