



Rosemont Road, W3

£435,000

A ground floor two bedroom apartment with over 650 sq.ft of living space. The flat has a separate kitchen, two double bedrooms, a private garden and will be sold with no onward chain.

Just over half a mile from Acton Main Line (Elizabeth line), West Acton (Central line) and Ealing Common (District and Piccadilly lines) tube stations.

Features

- Ground Floor Flat
- Two Double Bedrooms
- Separate Kitchen
- Private Garden
- No Onward Chain
- Gas Central Heating

Rosemont Road,
London, W3

Ground Floor

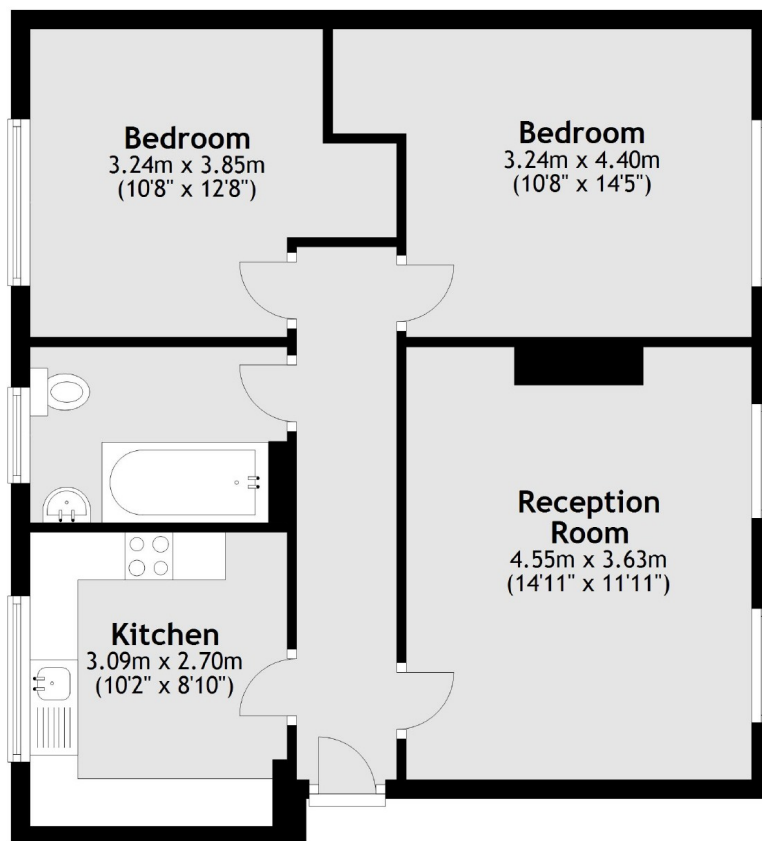

Total area: approx. 61.1 sq. metres (658.0 sq. feet)