



Property Description

Tastefully presented extended semi detached property situated within this popular development and within walking distance to Broseley town centre and both local primary schools. Accommodation includes, gas fired central heating, upvc double glazing, kitchen diner, sitting room, living room, three bedrooms, bathroom, low maintenance gardens to front and rear, ample parking and detached garage.

First Floor

Approx. 37.6 sq. metres (405.0 sq. feet)

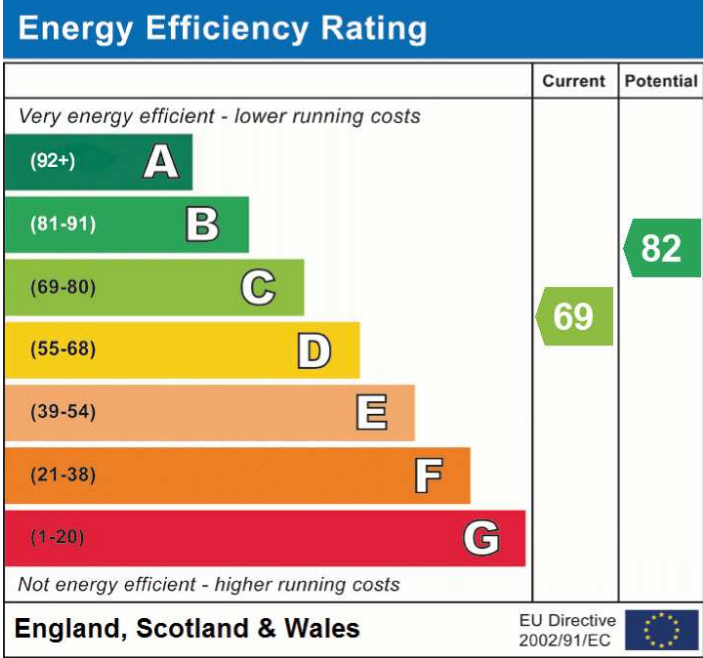
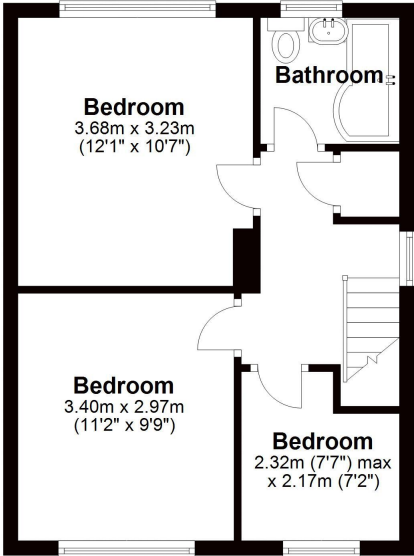

Address: Brookes Road, Broseley