



RESIDENCE

16 Dalzell Avenue, Motherwell, ML1 2BX

www.residencestateagents.co.uk



Viewing by appointment with Residence Hamilton
T: 01698 444333 | E: hamilton@residenceestateagents.co.uk | A: 34 Cadzow Street, Hamilton, ML3 6DG





4 Bedrooms | 2 Public Rooms | 2 Bathrooms

Situated within this desirable residential setting, this sizable 4 bedroomed chalet style detached villa is in need of modernisation and upgrading however offers excellent potential to be a wonderful family home.

The property is set within mature gardens with a sizable driveway and double detached garage. The accommodation comprises of a reception hallway with staircase to the upper floor level, lounge with aspects to rear, separate dining/family room with aspects to front, breakfasting size kitchen with outer door to the rear gardens. The property offers 4 bedrooms with 2 of them being on the ground floor level along with a family bathroom. The upper floor rooms are serviced by way of an additional shower room.

Features of the property include gas central heating and double glazing.

Dalzell Avenue is a desirable residential locale only a short drive away from the Town.

Motherwell provides a wide choice of shopping facilities and several highly regarded schools. The area has a wide choice of sports facilities, such as golf, tennis, bowling, swimming and country parks including the nearby Strathclyde Country Park and Chatelherault Parks. For those commuting by bus or train there are excellent and regular links to the surrounding towns and cities including Glasgow and Edinburgh.



sq ft | EER =



RESIDENCE





Dalzell Avenue

GROUND FLOOR

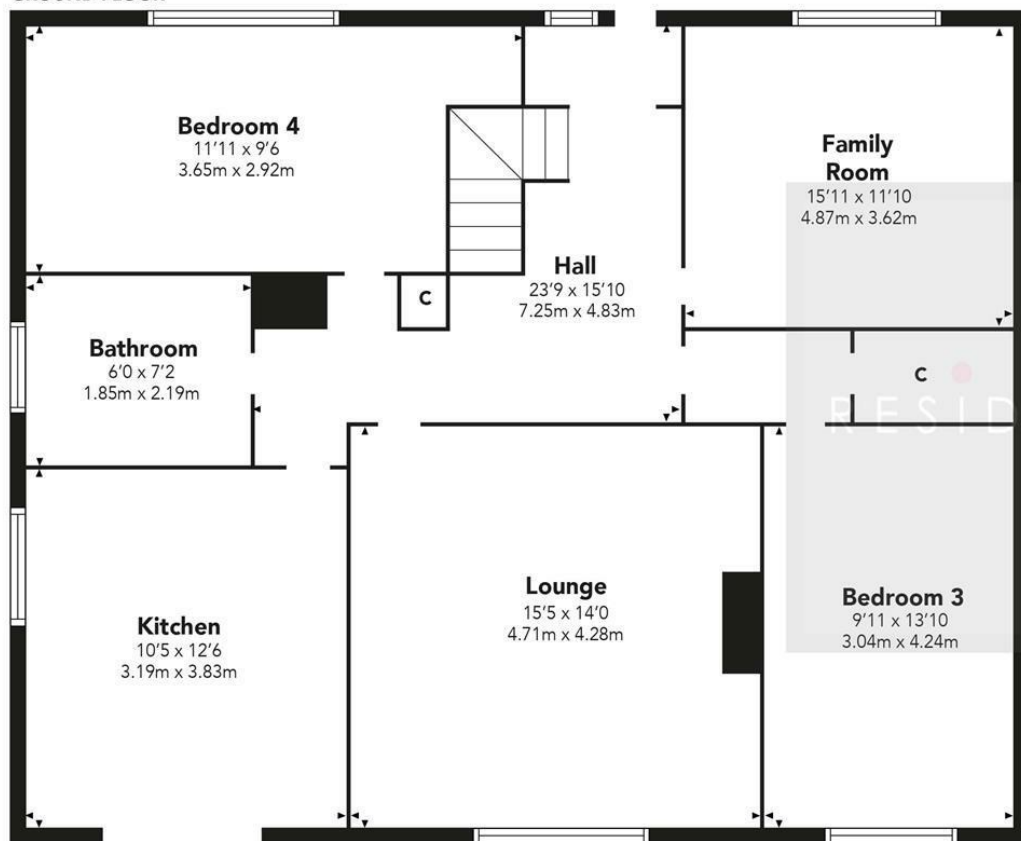

FIRST FLOOR

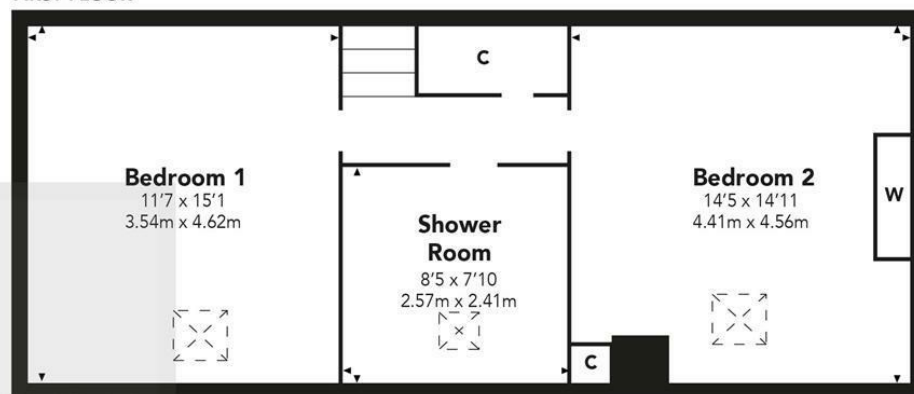

Floor Plan measurements are approximate and are for illustrative purposes only. While we do not doubt the floor plans accuracy, we make no guarantee, warranty or representation as to the accuracy and completeness of the floor plan. You or your advisors should conduct a careful, independent investigation of the property to determine to your satisfaction as to the suitability of the property for your space requirements.

Produced by Plush Plans Ltd

We believe these details to be accurate; however, they do not form any part of a contract. Fixtures and fittings are not included unless specified in the enclosed. Photographs are for general information and it must not be inferred that any item is included for sale with the property. All distances and measurements are approximate. Floorplans may not be to scale and are for illustration purposes only.