



Queen Elizabeth Road,
Lincoln



2



2



1

£149,950

- Semi-Detached
- Two Bedrooms
- Popular Location
- Open Plan Living Room/ Kitchen
- Gas Central Heating
- WC and Bathroom
- NO ONWARD CHAIN
- EPC rating TBC



Well presented two bedroom, mid-terrace house located to the North of Lincoln. Ideally position within walking distance of the local shops and bus stop.

The property consists of open plan kitchen living area and WC to the ground floor. To the first floor there are two double bedrooms and family bathroom. Outside the property there is a courtyard garden to the rear and allocated parking.

The property benefits from being sold with NO ONWARD CHAIN.

Openplan Living Kitchen Area

External door and window to front aspect and french doors to rear aspect.

Kitchen Area

Fitted with a range of wall and base units with worktops over, sink with drainer, electric oven, four ring gas hob with extractor over, space and plumbing for both washing machine and dishwasher. space for fridge and freezer and understairs storage area.



Living Area

Radiator.

WC

Fitted with low level WC, wash hand basin and extractor.

Landing

Access to roof space.

Bedroom One

Window to rear aspect and radiator.

Bedroom Two

Window to front aspect, storage cupboard and radiator.

Bathroom

Fitted with panel bath with shower over, low level WC, wash hand basin, radiator, and extractor.

Outside

To the rear of the property there is an enclosed courtyard.

Agent Note

These particulars are issued in good faith but do not constitute representations of fact or form part of any offer or contract. The matters referred to in these particulars should be independently verified by prospective buyers or tenants. Neither Newton Fallowell nor any of its employees or agents has any authority to make or give any representation or warranty whatever in relation to this property.

GROUND FLOOR
284 sq.ft. (26.4 sq.m.) approx.

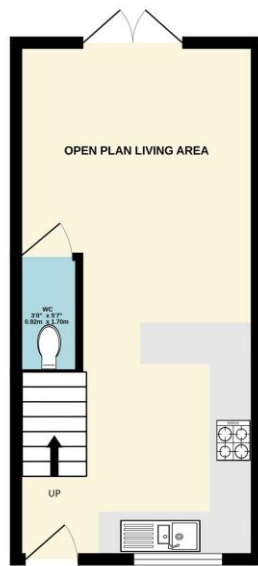

1ST FLOOR
284 sq.ft. (26.4 sq.m.) approx.

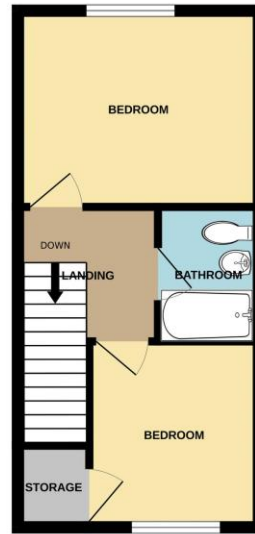

QUEEN ELIZABETH ROAD, LINCOLN, LN1 3QG

TOTAL FLOOR AREA : 569 sq.ft. (52.9 sq.m.) approx.

Whilst every attempt has been made to ensure the accuracy of the floorplan contained here, measurements of floor, window, room and any other items are approximate and no responsibility is taken for any error, omission or mis-statement. This plan is for illustrative purposes only and should be used as such by any prospective purchaser. The services, systems and appliances shown have not been tested and no guarantee as to their condition or efficiency can be given.
Made with Metropix 13/2/24

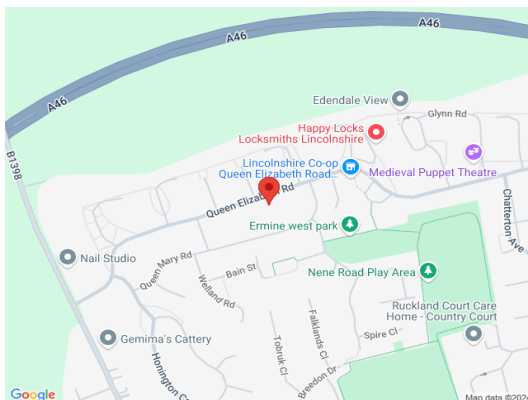

Newton Fallowell Lincoln

01522 516590

lincoln@newtonfallowell.co.uk