



Boultham Avenue, Lincoln

 3  1  2

£175,000



Key Features

- Terrace House
- Three Bedrooms
- Two Reception Rooms
- Bay Fronted
- NO ONWARD CHAIN
- River Views
- EPC rating D
- Freehold





Well presented, three bedroom terrace house, located in the popular location of Boultham Avenue, with river views and character features, and with in walking distance of local amenities.

The property consists of entrance hall, bay fronted lounge, dining room, kitchen, and family bathroom to the ground floor. To the first floor there are three bedrooms. Outside the property to the rear there is an enclosed garden with decking area and out building. The property also benefits from being sold with NO ONWARD CHAIN.

Entrance Hall

External door to side aspect and stairs to the first floor.

Lounge 3.81m x 3.67m (12'6" x 12'0")

Bay window to front aspect, feature fireplace, and radiator.

Dining Room 3.81m x 3.67m (12'6" x 12'0")

Window to rear aspect, feature fireplace, understair cupboard and radiator.

Kitchen 4.41m x 2.49m (14'6" x 8'2")

Window and external door to side aspect and fitted with a range of wall and base units with worktops over, sink with drainer, multi fuel range cooker with extractor over, space and plumbing for both dishwasher and washing machine, space for fridge freezer and radiator.

Bathroom 2.00m x 1.89m (6'7" x 6'2")

Window to side aspect and fitted with panel bath with shower over, low level WC, wash hand basin and radiator.

Landing

Access to roof space.

Bedroom One 3.68m x 3.67m (12'1" x 12'0")

Window to rear aspect, storage cupboard and radiator.

Bedroom Two 3.43m x 1.97m (11'4" x 6'6")

Window to front aspect and radiator.

Bedroom Three 2.63m x 2.61m (8'7" x 8'7")

Window to front aspect and radiator.

Outside

To rear of the property there is an enclosed garden with , large decking area and out building and storage shed.

Agent Note

These particulars are issued in good faith but do not constitute representations of fact or form part of any offer or contract. The matters referred to in these particulars should be independently verified by prospective buyers or tenants. Neither Newton Fallowell nor any of its employees or agents has any authority to make or give any representation or warranty whatever in relation to this property.





GROUND FLOOR
499 sq.ft. (46.4 sq.m.) approx.

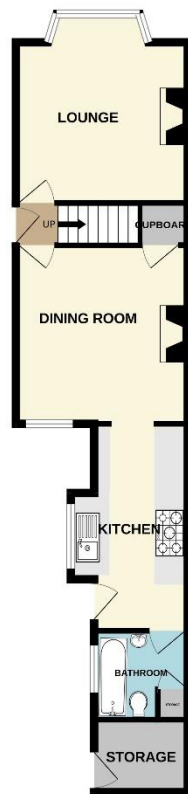

1ST FLOOR
355 sq.ft. (33.0 sq.m.) approx.

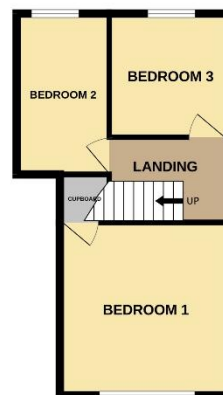

TOTAL FLOOR AREA : 854 sq.ft. (79.3 sq.m.) approx.

Whilst every attempt has been made to ensure the accuracy of the floorplan contained here, measurements of doors, windows, rooms and any other items are approximate and no responsibility is taken for any error, omission or mis-statement. This plan is for illustrative purposes only and should be used as such by any prospective purchaser. The services, systems and appliances shown have not been tested and no guarantee as to their operability or efficiency can be given.
Made with Metropix ©2024



Score	Energy rating	Current	Potential
92+	A		
81-91	B		84 B
69-80	C		
55-68	D	65 D	
39-54	E		
21-38	F		
1-20	G		

