



Meadow Way, Lincoln



OIRO £180,000



## Key Features

- Semi-Detached House
- Gated Driveway and Garage
- NO ONWARD CHAIN
- Two Bedroom
- Popular Village Location
- Amenities & Schooling Nearby
- EPC rating D
- Freehold





Well presented, two bedroom semi-detached house. Located in the highly sought after village of Bracebridge Heath. Located within walking distance of local schools, shops and other amenities.

The property offers internally lounge, kitchen and dining room to the ground floor. To the first floor there are two bedrooms and bathroom. Outside the property to the front there is a lawned garden and gated driveway leading to a detached single garage. To the rear of the property there is an enclosed lawned garden.

The property benefits from being sold with NO ONWARD CHAIN

#### **Lounge** 3.89m x 4.57m (12'10" x 15'0")

External door and bay window to front aspect, feature fireplace, understairs cupboard, stairs to first floor and radiator.

#### **Kitchen Diner** 2.06m x 4.59m (6'10" x 15'1")

Windows to rear aspect and fitted with a range of wall and base units with worktops over, sink with drainer, electric oven, four ring electric hob with extractor over and space and plumbing for washing machine.

#### **Landing**

Access to roof space

#### **Bedroom One** 3.04m x 4.59m (10'0" x 15'1")

Windows to front aspect, storage cupboard and radiator.

#### **Bedroom Two** 2.38m x 2.39m (7'10" x 7'10")

Window to rear aspect and radiator.

#### **Bathroom** 2.06m x 2.18m (6'10" x 7'2")

Window to rear aspect and fitted with panel bath with shower over, low level WC, wash hand basin and radiator.

#### **Outside**

To the front of the property there is a lawned garden and gated driveway leading to a detached single garage. To the rear of the property there is an enclosed lawned garden.

#### **Agent Note**

These particulars are issued in good faith but do not constitute representations of fact or form part of any offer or contract. The matters referred to in these particulars should be independently verified by prospective buyers or tenants. Neither Newton Fallowell nor any of its employees or agents has any authority to make or give any representation or warranty whatever in relation to this property.



GROUND FLOOR  
413 sq.ft. (38.4 sq.m.) approx.

1ST FLOOR  
264 sq.ft. (24.5 sq.m.) approx.

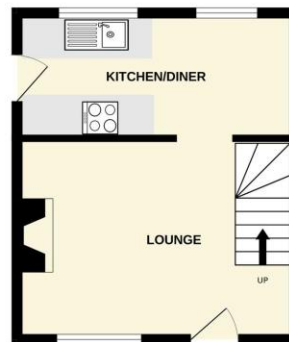
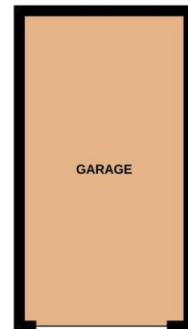

MEADOW WAY, BRACEBRIDGE HEATH LN4 2QP

TOTAL FLOOR AREA : 678 sq.ft. (62.9 sq.m.) approx.

Whilst every attempt has been made to ensure the accuracy of the floorplan contained here, measurements of doors, windows, rooms and any other items are approximate and no responsibility is taken for any error, omission or mis-statement. This plan is for illustrative purposes only and should be used as such by any prospective purchaser. The services, systems and appliances shown have not been tested and no guarantee as to their operability or efficiency can be given.  
Made with Metropix ©2024

