



The Cottage, Back Lane,
Westborough, Newark. NG23 5HH



£275,000

- Semi Detached Period Cottage
- Delightful Village Location
- Adjoining Paddock Available
- Living Room with open fire
- Boot Room
- Kitchen & Boiler Room
- Bathroom/WC
- Two Bedrooms
- Garage & Stables
- Freehold – Energy Rating E



A semi-detached period brick and pantile cottage in a delightful village position and offering comfortable two bedroomed accommodation with some scope for improvement and room to extend should additional living space be desired. There is adequate parking for a number of vehicles and gardens to three sides. A grass paddock to the rear is available to PURCHASE OR RENT if required. Vacant possession and no onward chain.

ACCOMMODATION

HALL/BOOT ROOM

1.79m x 3.49m (5'11" x 11'6")

With wooden stable door, two uPVC double glazed window to the rear elevation, tiled floor and radiator. A half glazed door leads to the dining room.

DINING ROOM

3.66m x 3.83m (12'0" x 12'6") maximum, 'L' shaped

Having a wide uPVC double glazed picture window to the side elevation and further uPVC double glazed window to the front, tiled floor and radiator.

BATHROOM

1.32m x 2.60m (4'4" x 8'6")

Containing a white suite comprising panelled bath with power shower and glazed screen over, pedestal wash handbasin and low level WC., tiled walls, heated towel rail, fitted cabinet and mirror and uPVC obscure double glazed window to the rear elevation.





KITCHEN

1.95m x 4.29m (6'5" x 14'1")

Having uPVC double glazed window to the front elevation and fitted with a range of walnut style units comprising base cupboards and drawers with work surfaces over and a wall cupboard, work surface with inset one and a half bowl stainless steel sink with mixer tap, slot-in Rangemaster cooker with ceramic hob, tiled floor, half tiled walls, radiator, beamed ceiling and under stairs shelved pantry area and electrical consumer unit. A staircase leads off from the kitchen to the first floor, there is an inner window to the rear and central heating thermostat.

LIVING ROOM

4.00m x 4.39m (13'1" x 14'5")

With uPVC double glazed window to the front elevation, radiator, beamed ceiling and brick open fireplace with wooden mantel and quarry tiled hearth.

BOILER ROOM

1.37m x 2.56m (4'6" x 8'5")

Containing a Firebird Enviromax floor mounted oil fired boiler and having tiled floor, space and plumbing for washing machine and uPVC double glazed window to the rear elevation.

FIRST FLOOR LANDING

With uPVC double glazed window to the front elevation.

BEDROOM 1

3.99m x 4.42m (13'1" x 14'6")

Having uPVC double glazed window to the front and rear elevation and radiator, loft hatch to roof space and built-in double wardrobe cupboard.

BEDROOM 2

1.96m x 4.31m (6'5" x 14'1")

With uPVC double glazed window to the front and rear elevation, radiator and built-in airing cupboard containing insulated hot water cylinder with electric immersion heater and cold water tanks.

OUTSIDE

The cottage stands in a secluded village position with double wooden gates opening to an extensive driveway and leading to the garage and stables at the rear.

The front garden is enclosed by a conifer hedge and laid to lawn. There is a Yew tree and mature apple tree. The rear garden is laid generally to lawn with flower borders and oil storage tank. There is also a brick and pantile outbuilding. There is a generous parking area for a number of vehicles and a metal gate opens to the timber stables. A farm gate opens to a paddock at the rear which is available for purchase or rent if required. (The paddock has a right-of-way to one side).

BARN 1

1.34m x 1.39m (4'5" x 4'7")

BARN 2

1.48m x 1.58m (4'11" x 5'2")

DOUBLE GARAGE

4.70m x 5.70m (15'5" x 18'8")

Of timber and corrugated panel construction with up-and-over door.

STABLE 1

3.43m x 3.47m (11'4" x 11'5")

Both stables of timber construction erected on a concrete base with cold water tap.

STABLE 2

2.88m x 2.99m (9'5" x 9'10")

SERVICES

Mains electricity, water and drainage are connected. Oil fired central heating is installed.





COUNCIL TAX

The property is in Council Tax Band B.

DIRECTIONS

The property can be accessed from Long Bennington via Bennington Lane and Town Street and can be located off Long Lane.

WESTBOROUGH VILLAGE

Westborough is a designated conservation area within easy access of the A1 and only 1 mile from Long Bennington. Long Bennington offers excellent amenities and is within the catchment area for schools to Grantham and Newark. Long Bennington also has excellent amenities including Primary School, Co-op, Dispensing Surgery, Coffee Shop, Post Office (limited days) etc.

Grantham is 9 miles south and offers excellent schools and main line station to London King's Cross. In the opposite direction, Newark is just under 10 miles north situated just off the A1 and A46. It has 2 railway stations including Northgate Station which is on the east coast main line.

AGENT'S NOTE

Please note these particulars may be subject to change and must not be relied upon as an entirely accurate description of the property.

Although these particulars are thought to be materially correct, their accuracy cannot be guaranteed and they do not form part of any contract. Some measurements are overall measurements and others are maximum measurements. All services and appliances have not and will not be tested.

NOTE

Anti-Money Laundering Regulations – Intending purchasers will be asked to produce identification documentation at the offer stage and we would ask for your co-operation in order that there will be no delay in agreeing a sale.

Newton Fallowell and our partners provide a range of services to buyers, although you are free to use an alternative provider. If you require a solicitor to handle your purchase and/or sale, we can refer you to one of the panel solicitors we use. We may receive a fee of up to £300 if you use their services. If you need help arranging finance, we can refer you to the Mortgage Advice Bureau who are in-house. We may receive a fee of £250 if you use their services.

For more information please call in the office or telephone 01476 591900.



Floorplan

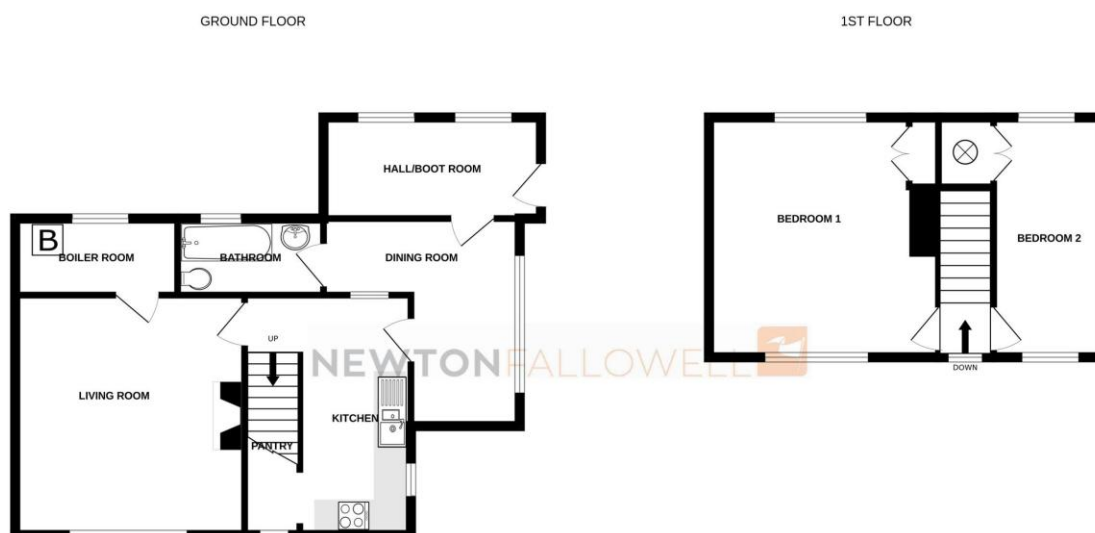

Whilst every attempt has been made to ensure the accuracy of the floorplan contained here, measurements of doors, windows, rooms and any other items are approximate and no responsibility is taken for any error, omission or mis-statement. This plan is for illustrative purposes only and should be used as such by any prospective purchaser. The services, systems and appliances shown have not been tested and no guarantee as to their operability or efficiency can be given.
Made with Metropix ©2024



Newton Fallowell
68 High Street, Grantham, Lincs. NG31 6NR
01476 591900
grantham@newtonfallowell.co.uk