

HUNTERS[®]

HERE TO GET *you* THERE



Blanchdowne

London, SE5 8HT

£2,600 Per Calendar Month



Three double bedroom terraced house with private rear garden.

This well proportioned property benefits from three good sized double bedrooms, spacious separate reception, modern kitchen diner with integrated appliances and contemporary bathroom with bath and shower fitting.

To the rear of the property is a private south west facing garden the perfect entertainment space for for summer evenings.

Minutes from Denmark Hill overland station with easy access to the West End & City and a vast range of bars, restaurants and local amenities.

Kings College hospital and the beautiful Ruskin Park are both a short walk away.



Area Map



Floor Plans

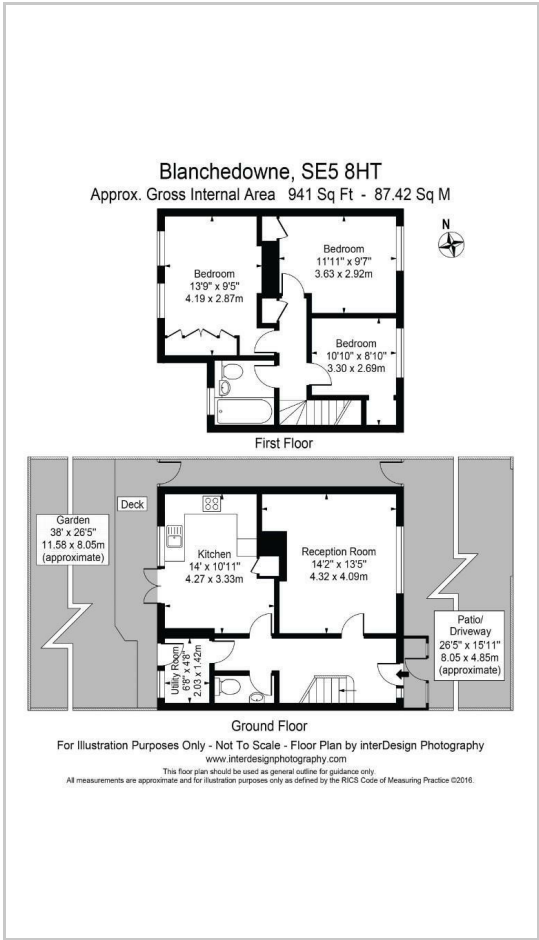

Energy Efficiency Graph

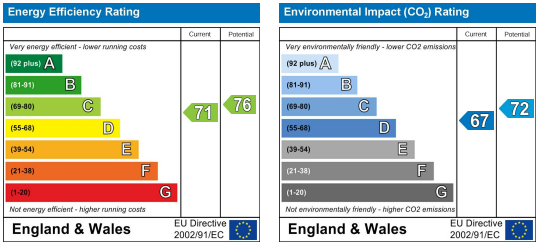

These particulars are intended to give a fair and reliable description of the property but no responsibility for any inaccuracy or error can be accepted and do not constitute an offer or contract. We have not tested any services or appliances (including central heating if fitted) referred to in these particulars and the purchasers are advised to satisfy themselves as to the working order and condition. If a property is unoccupied at any time there may be reconnection charges for any switched off/disconnected or drained services or appliances - All measurements are approximate.

THINKING OF SELLING? If you are thinking of selling your home or just curious to discover the value of your property, Hunters would be pleased to provide free, no obligation sales and marketing advice. Even if your home is outside the area covered by our local offices we can arrange a Market Appraisal through our national network of Hunters estate agents.