

HUNTERS®

HERE TO GET *you* THERE



Gables Close

London, SE5 7QE

£1,800

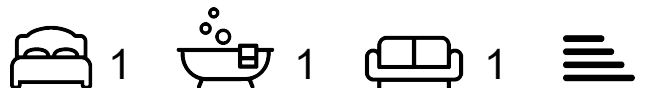

Spacious one bed period conversion with private south facing balcony.

This fantastic one-bedroom apartment forms part one of the most iconic buildings in Camberwell. Built in 1890 the tower was originally part of the St Giles' Infirmary.

Benefiting from a large open plan reception containing a modern fitted kitchen with a range of integrated appliances. The contemporary bathroom contains both bath and shower fitting. The good sized double bedroom has ample storage.

The large south facing wrap around balcony is accessed via the reception.

There is a dedicated off street parking space.



Area Map



Floor Plans

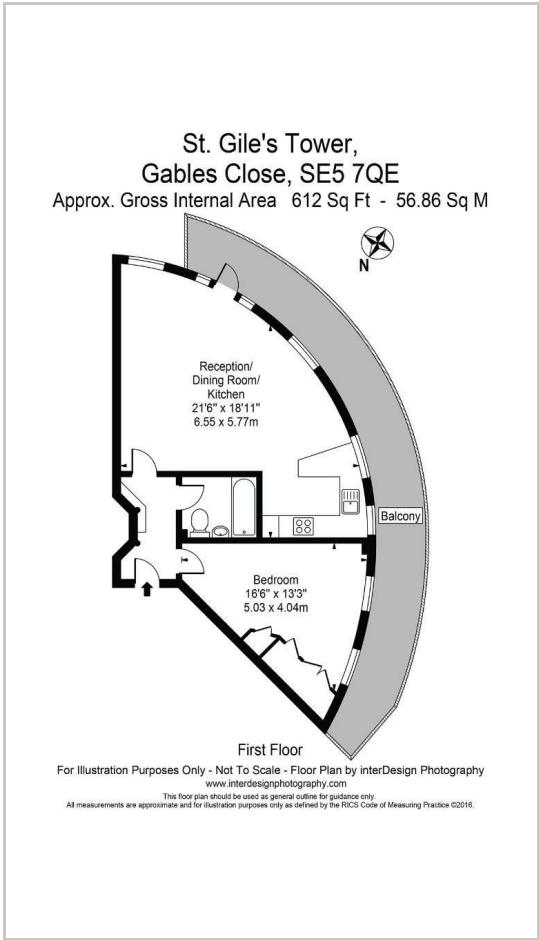

Energy Efficiency Graph



These particulars are intended to give a fair and reliable description of the property but no responsibility for any inaccuracy or error can be accepted and do not constitute an offer or contract. We have not tested any services or appliances (including central heating if fitted) referred to in these particulars and the purchasers are advised to satisfy themselves as to the working order and condition. If a property is unoccupied at any time there may be reconnection charges for any switched off/disconnected or drained services or appliances - All measurements are approximate.

THINKING OF SELLING? If you are thinking of selling your home or just curious to discover the value of your property, Hunters would be pleased to provide free, no obligation sales and marketing advice. Even if your home is outside the area covered by our local offices we can arrange a Market Appraisal through our national network of Hunters estate agents.