

HUNTERS®

HERE TO GET *you* THERE



Grovelands Close

London, SE5 8JN

£1,650



Spilt level one bed house with private patio garden.

Sitting within a private development off the famous Camberwell Grove, this well proportioned one bed house benefits from a spacious open plan reception with modern fitted kitchen. To the front of the property is a private south facing patio garden.

Upstairs is a large double bedroom and newly fitted bathroom with both bath and shower fitting.

Grovelands Close is a well maintained private estate that is a haven of peace and tranquillity yet in the heart of Zone 2 Central London.

Minutes from excellent transport links including Denmark Hill overland station with easy access to the West End & City.



Area Map



Floor Plans

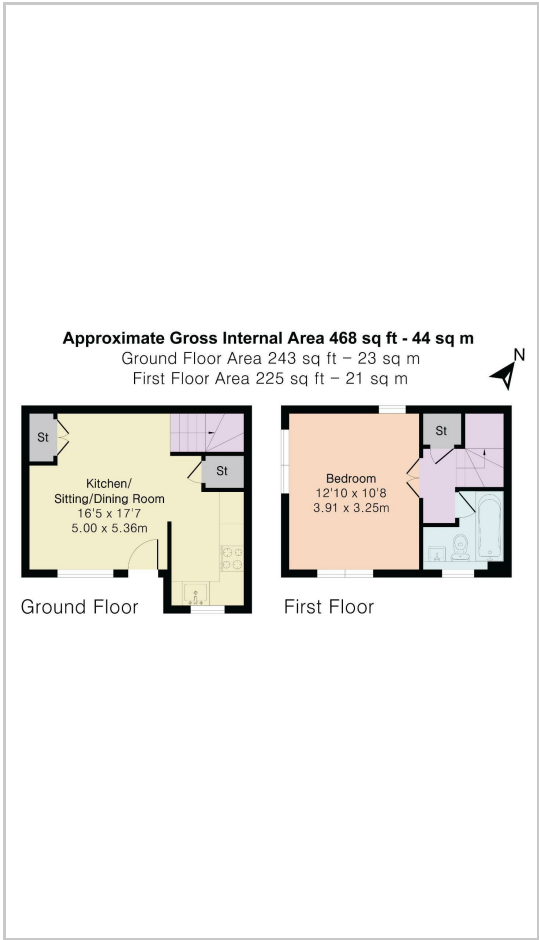

Energy Efficiency Graph

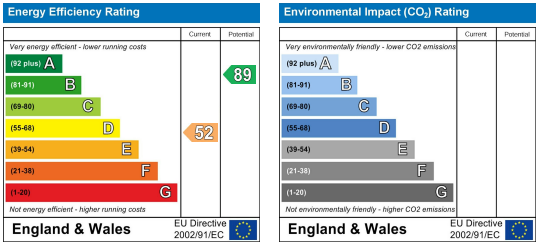

These particulars are intended to give a fair and reliable description of the property but no responsibility for any inaccuracy or error can be accepted and do not constitute an offer or contract. We have not tested any services or appliances (including central heating if fitted) referred to in these particulars and the purchasers are advised to satisfy themselves as to the working order and condition. If a property is unoccupied at any time there may be reconnection charges for any switched off/disconnected or drained services or appliances - All measurements are approximate.

THINKING OF SELLING? If you are thinking of selling your home or just curious to discover the value of your property, Hunters would be pleased to provide free, no obligation sales and marketing advice. Even if your home is outside the area covered by our local offices we can arrange a Market Appraisal through our national network of Hunters estate agents.