

HUNTERS®

HERE TO GET *you* THERE



De Crespigny Park

London, SE5 8AB

£1,650 Per Calendar Month



Stunning top floor 1 bed period conversion in the heart of Denmark Hill.

This well-proportioned one bed apartment sits at the top of an imposing Georgian house and benefits from a good sized double bedroom with built in storage, spacious separate reception with breakfast bar area and modern fitted kitchen & bathroom.

To the rear of the property is a large, well maintained communal garden with BBQ area.

A short walk to excellent transport links including Denmark Hill overland station with easy access to the West End & City, Kings College Hospital and a vast range of bars restaurants and local amenities nearby.

Brixton with its vibrant entertainment scene is a short hop way.



Area Map



Floor Plans

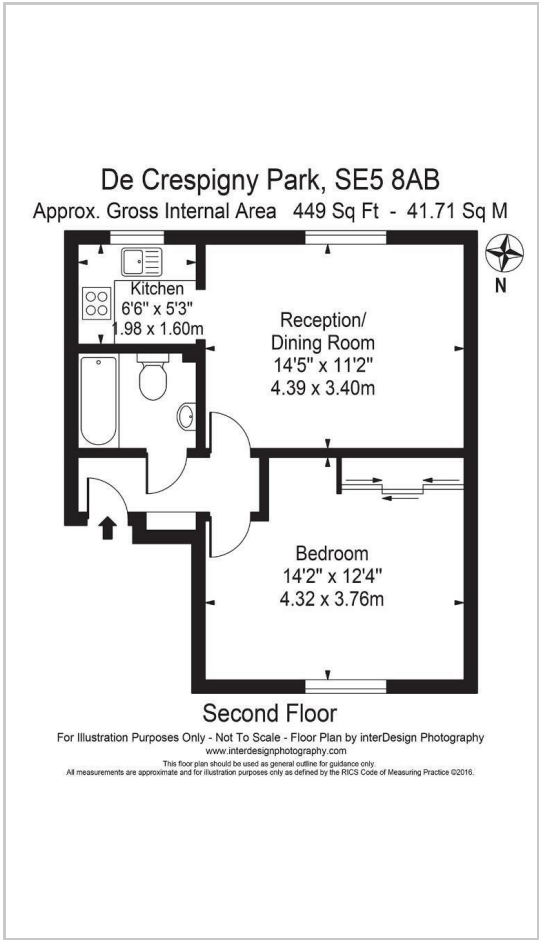

Energy Efficiency Graph

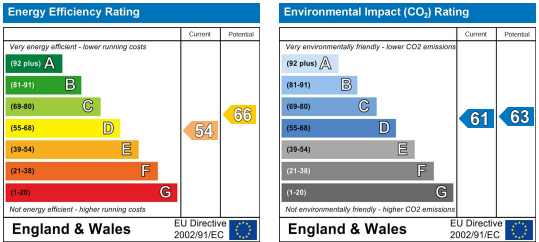

These particulars are intended to give a fair and reliable description of the property but no responsibility for any inaccuracy or error can be accepted and do not constitute an offer or contract. We have not tested any services or appliances (including central heating if fitted) referred to in these particulars and the purchasers are advised to satisfy themselves as to the working order and condition. If a property is unoccupied at any time there may be reconnection charges for any switched off/disconnected or drained services or appliances - All measurements are approximate.

THINKING OF SELLING? If you are thinking of selling your home or just curious to discover the value of your property, Hunters would be pleased to provide free, no obligation sales and marketing advice. Even if your home is outside the area covered by our local offices we can arrange a Market Appraisal through our national network of Hunters estate agents.