

HUNTERS[®]

HERE TO GET *you* THERE



Telford Court

SW2 4RH

£2,500 Per Calendar Month



This purpose built spacious three bedder forms part of a beautiful Victorian mansion block in the heart of Zone 2 central London.

The apartment boasts three good sized double bedrooms, large separate reception and modern fitted kitchen and bathroom.

The development also comes with well manicured communal gardens and stunning panoramic views across the Capital.

A short hop to excellent transport links and amenities. Brixton with its vibrant entertainment scene is a short bus ride away.

Comes furnished and is available from end of September.

Local Authority - Lambeth
Council Tax - C



Area Map

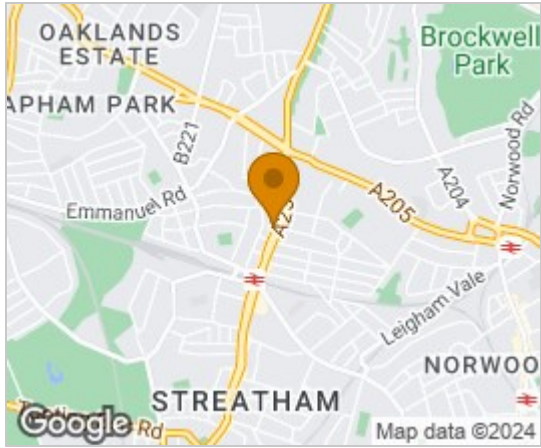

Floor Plans

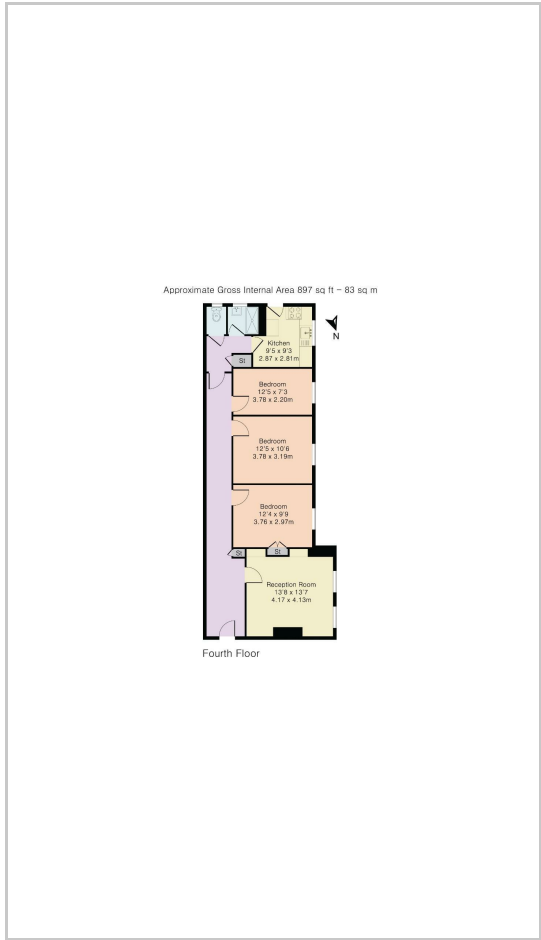

Energy Efficiency Graph

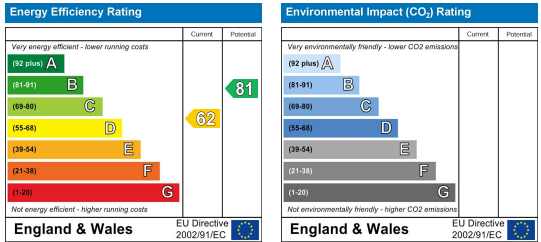

These particulars are intended to give a fair and reliable description of the property but no responsibility for any inaccuracy or error can be accepted and do not constitute an offer or contract. We have not tested any services or appliances (including central heating if fitted) referred to in these particulars and the purchasers are advised to satisfy themselves as to the working order and condition. If a property is unoccupied at any time there may be reconnection charges for any switched off/disconnected or drained services or appliances - All measurements are approximate. **THINKING OF SELLING?** If you are thinking of selling your home or just curious to discover the value of your property, Hunters would be pleased to provide free, no obligation sales and marketing advice. Even if your home is outside the area covered by our local offices we can arrange a Market Appraisal through our national network of Hunters estate agents.