



Mary Datchelor Close

SE5 7DY

£1,700 Per Calendar Month



HEATING BILLS INCLUDED. Spacious purpose built one bed apartment with private rear garden in the heart of Zone 2.

This well-proportioned one double bedroom apartment sits a short walk from Camberwell Green and benefits from a good-sized double bedroom with built in storage, spacious separate reception that leads to a private south west facing patio garden.

There is a modern style kitchen with built in appliances and family bathroom with bath and shower fitting. There is ample storage throughout.

Minutes from excellent transport links with easy access into the West End & City and a vast range of bars, restaurants and local amenities that this vibrant part of London has to offer.

The property comes unfurnished and is available from end of September.



Area Map



Floor Plans

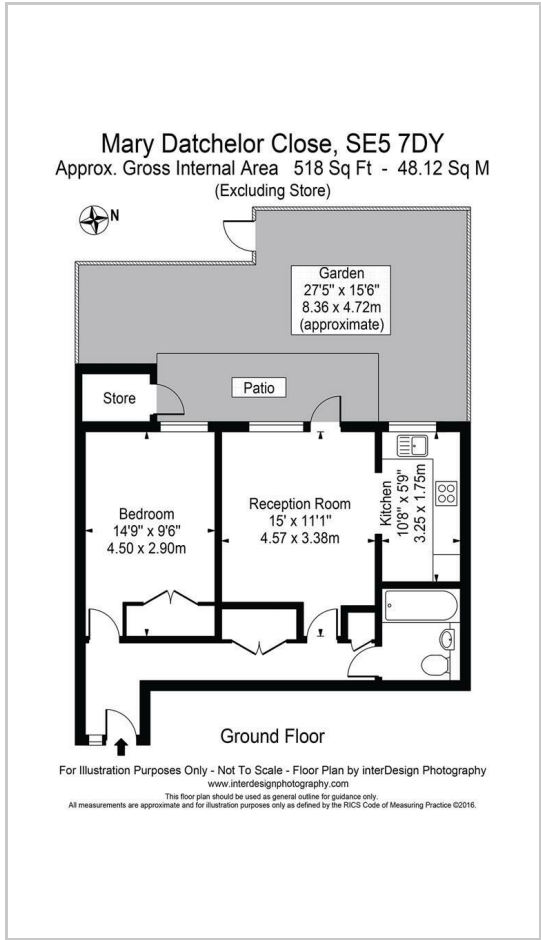

Energy Efficiency Graph

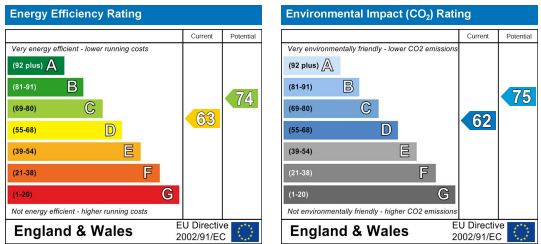

These particulars are intended to give a fair and reliable description of the property but no responsibility for any inaccuracy or error can be accepted and do not constitute an offer or contract. We have not tested any services or appliances (including central heating if fitted) referred to in these particulars and the purchasers are advised to satisfy themselves as to the working order and condition. If a property is unoccupied at any time there may be reconnection charges for any switched off/disconnected or drained services or appliances - All measurements are approximate. **THINKING OF SELLING?** If you are thinking of selling your home or just curious to discover the value of your property, Hunters would be pleased to provide free, no obligation sales and marketing advice. Even if your home is outside the area covered by our local offices we can arrange a Market Appraisal through our national network of Hunters estate agents.