



ASKING PRICE

£648,000



THE DETAILS



Furness Fells, 24 Cronk Drean

Douglas

£648,000

call in today or visit www.blackgracecowley.com for more details

e: hello@blackgracecowley.com | w: blackgracecowley.com | t: +44 (0) 1624 645555

a: 51 Victoria Street, DOUGLAS, Isle of Man, IM1 2LD





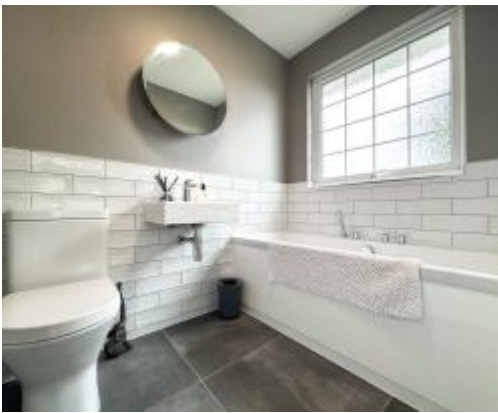







PROPERTY DETAILS FOR

Furness Fells, 24 Cronk Drean, Douglas

THE DESCRIPTION

- Fantastic, detached family home in a sought-after location in Douglas
- Superb, recently fitted Breakfast Kitchen with Dining Room
- 4 double Bedrooms, 2 Reception Rooms, downstairs W.C.
- Newly fitted En Suite Bathroom and Shower Room
- Integral double Garage with large driveway
- Enclosed, private rear garden, lawned side and front gardens
- uPVC double glazing and gas fired central heating
- Viewing highly recommended
- No onward chain

THE PROPERTY

Black Grace Cowley are delighted to be given the opportunity to market this superb, recently refurbished detached family home in Cronk Drean, this well-established and sought after residential estate in upper Douglas. Occupying a slightly elevated position, on a good-sized corner plot, accessible from a large 4 car driveway and apron. Attractive Spanish porcelain tiles (Pamesa) add a touch of elegance to the Hallway, 4 double Bedrooms, 2 Reception Rooms, downstairs WC, a large newly fitted Breakfast Kitchen and 2 newly fitted Bathrooms comprising En Suite Bathroom and Family Shower Room. Insulated attic space.

In addition, the property benefits from a large integral double garage, front and side gardens with a private enclosed rear lawned garden and raised patio area for outdoor entertaining.

uPVC double glazing and gas fired central heating. All mains services are installed.

No onward chain. Viewing essential.

e: hello@blackgracecowley.com | w: blackgracecowley.com | t: +44 (0) 1624 645555

a: 51 Victoria Street, DOUGLAS, Isle of Man, IM1 2LD

FLOORPLAN

GROUND FLOOR
1184 sq.ft. (110.0 sq.m.) approx.

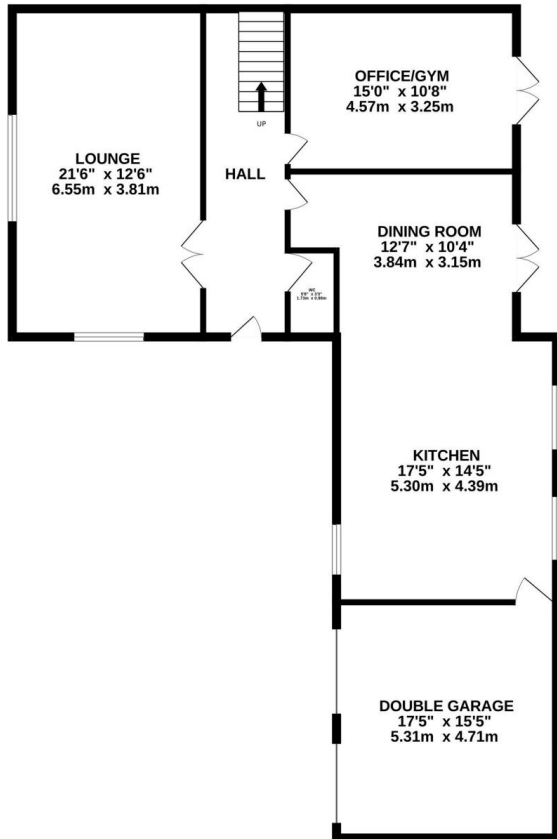

1ST FLOOR
655 sq.ft. (60.8 sq.m.) approx.

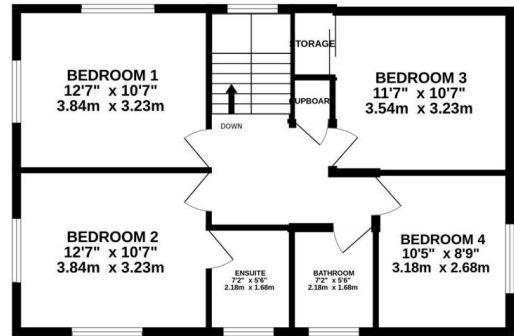

TOTAL FLOOR AREA: 1839 sq.ft. (170.8 sq.m.) approx.

Whilst every attempt has been made to ensure the accuracy of the floorplan contained here, measurements of doors, windows, rooms and any other items are approximate and no responsibility is taken for any error, omission or mis-statement. This plan is for illustrative purposes only and should be used as such by any prospective purchaser. The services, systems and appliances shown have not been tested and no guarantee as to their operability or efficiency can be given.
Made with Metropix ©2024



PROPERTY DETAILS FOR

Furness Fells, 24 Cronk Drean, Douglas

Disclaimer

These particulars are for information purposes only and do not constitute or form any contract nor should any statement contained herein be relied upon as a representation of fact.

Neither the vendor nor Black Grace Cowley (the firm), nor any officer or employee of the firm accept liability or responsibility for any statement contained herein.

The vendor does not by these particulars, nor does the firm, nor does any officer or any employee of the firm have any authority to make or give any representation or warranty whatsoever as regards the property or otherwise. It is the sole responsibility of any person interested in the property described in these particulars to make all proper enquiries and searches to verify the description of the property and all other particulars herein.

e: hello@blackgracecowley.com | **w:** blackgracecowley.com | **t:** +44 (0) 1624 645555

a: 51 Victoria Street, DOUGLAS, Isle of Man, IM1 2LD