



ASKING PRICE

£975,000



## THE DETAILS



Waitara, Clifton Road

Port St Mary

£975,000

call in today or visit [www.blackgracecowley.com](http://www.blackgracecowley.com) for more details

e: [hello@blackgracecowley.com](mailto:hello@blackgracecowley.com) | w: [blackgracecowley.com](http://blackgracecowley.com) | t: +44 (0) 1624 645555

a: 51 Victoria Street, DOUGLAS, Isle of Man, IM1 2LD









PROPERTY DETAILS FOR

## Waitara, Clifton Road, Port St Mary

### THE DESCRIPTION

- Superb opportunity to purchase a fantastic residential development plot
- The plot benefits from spectacular sea views out across Perwick Bay
- Approximately 0.5 acres situated in a fantastic position
- Planning approved for 3 residential dwellings with garages (18/00764/A)
- Situated close to local amenities, harbour and golf links

### THE PROPERTY

#### DIRECTIONS

Enter Port St Mary and proceed along Bay View Road and around the one – way system. Take the second left on to Queens Road and proceed to the end. At the junction with Clifton Road, turn right and the site can be found a short distance on the right hand side.

#### PLANNING

Planning approved for 3 residential dwellings with garages (18/00764/A)

**SITE PLAN**

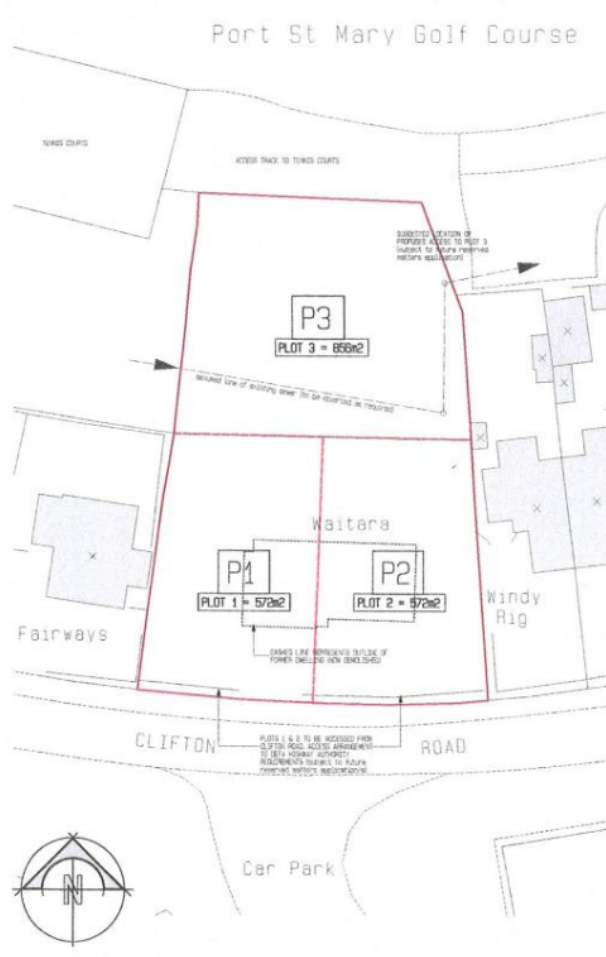

AERIAL IMAGES AS EXISTING (SEPT 2021)

APPROVAL BY PRINCIPLE FOR ERECTION OF 2x0 DETACHED DWELLINGS ON SITE OF WAITARA, CLIFTON ROAD, PORT ST MARY, DMU DEL.
MR DAVID TOMLINSON
<b>KELLY LEVITHWAITE BUILDING DESIGN LTD</b> 23 PRINCE STREET, DOUGLAS, ISLE OF MAN, IM1 1JH. TEL: 01624 711318 FAX: 01624 711319
ARCHITECTURAL DESIGN & CONSULTANCY
SCALE: 1:200 DRAWING NO: WA/23/1547

## SITE PLAN

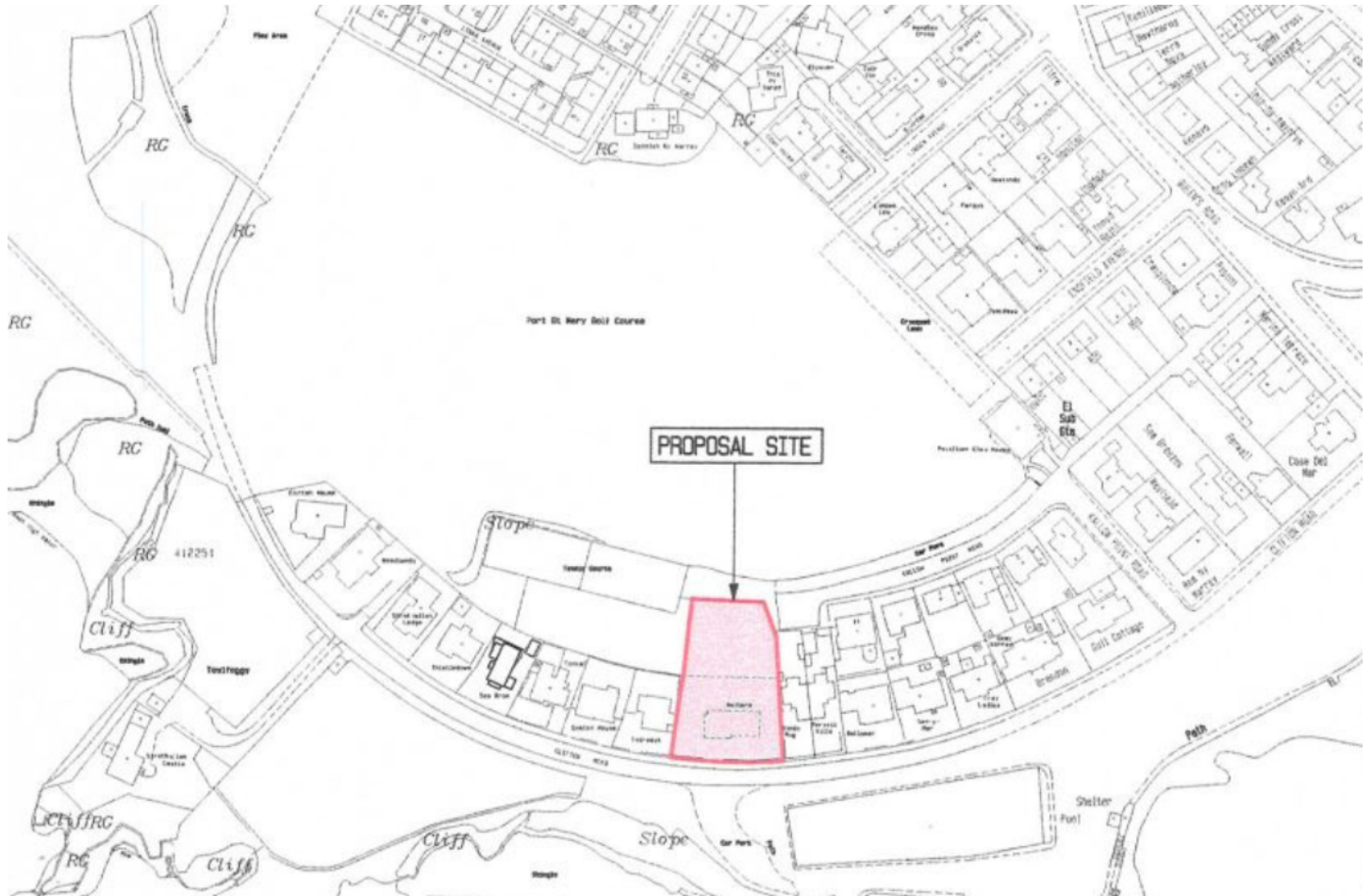

## SITE PLAN

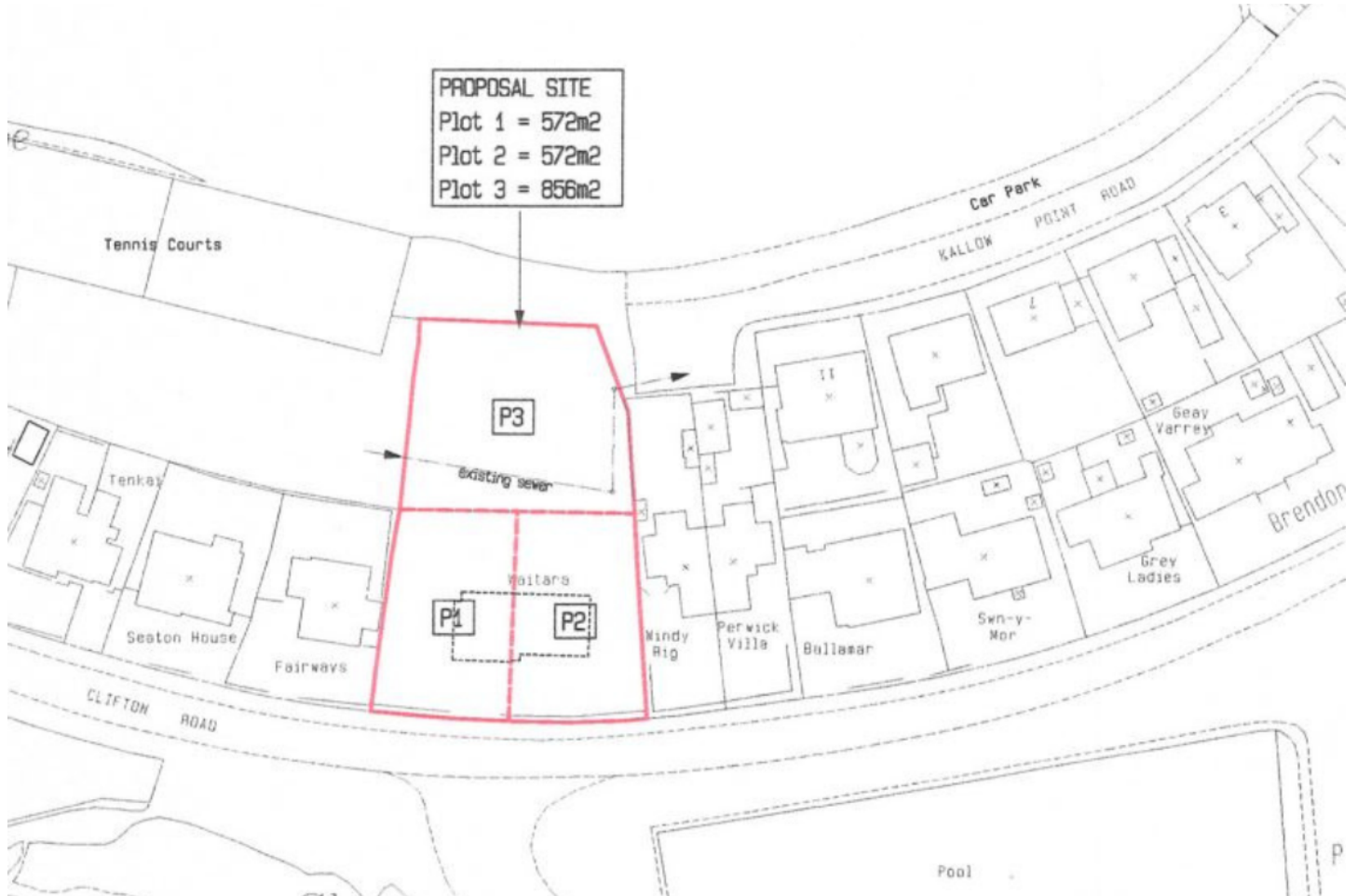





PROPERTY DETAILS FOR

# Waitara, Clifton Road, Port St Mary

## Disclaimer

These particulars are for information purposes only and do not constitute or form any contract nor should any statement contained herein be relied upon as a representation of fact.

Neither the vendor nor Black Grace Cowley (the firm), nor any officer or employee of the firm accept liability or responsibility for any statement contained herein.

The vendor does not by these particulars, nor does the firm, nor does any officer or any employee of the firm have any authority to make or give any representation or warranty whatsoever as regards the property or otherwise. It is the sole responsibility of any person interested in the property described in these particulars to make all proper enquiries and searches to verify the description of the property and all other particulars herein.

**e:** [hello@blackgracecowley.com](mailto:hello@blackgracecowley.com) | **w:** [blackgracecowley.com](http://blackgracecowley.com) | **t:** +44 (0) 1624 645555

**a:** 51 Victoria Street, DOUGLAS, Isle of Man, IM1 2LD