



Charles Henderson Mews, 11 Taylor Road

Romney Marsh

£525,000

2 Charles Henderson Mews

, Romney Marsh

Luxurious 4-bed detached house in desirable location with modern design. Ideal for family living with spacious rooms, garden, and integral garage. Conveniently close to shops and seafront, offering seamless indoor-outdoor living for modern families.

Tenure: Freehold

- Luxury Family Home
- Four Bedrooms
- Three Bathrooms
- Kitchen/Family Room
- Separate Lounge
- Master Bedroom Ensuite
- Four Double Bedrooms
- Low Maintenance Garden
- Close to Local Shops





Porch

Hallway

Living Room

10' 10" x 14' 2" (3.29m x 4.31m)

Kitchen/Family Room

26' 11" x 17' 9" (8.20m x 5.42m)

Utility Room

Shower Room

Integral Garage

10' 1" x 16' 4" (3.07m x 4.99m)

Landing

Master Bedroom

11' 3" x 15' 8" (3.43m x 4.77m)

Ensuite Shower Room

9' 2" x 6' 10" (2.79m x 2.08m)

Bedroom

10' 4" x 15' 8" (3.14m x 4.78m)

Bathroom

8' 10" x 8' 10" (2.68m x 2.69m)

Bedroom

9' 2" x 12' 0" (2.79m x 3.66m)

Bedroom

10' 9" x 9' 11" (3.28m x 3.01m)





Ground Floor

Approx. 103.5 sq. metres (1114.4 sq. feet)

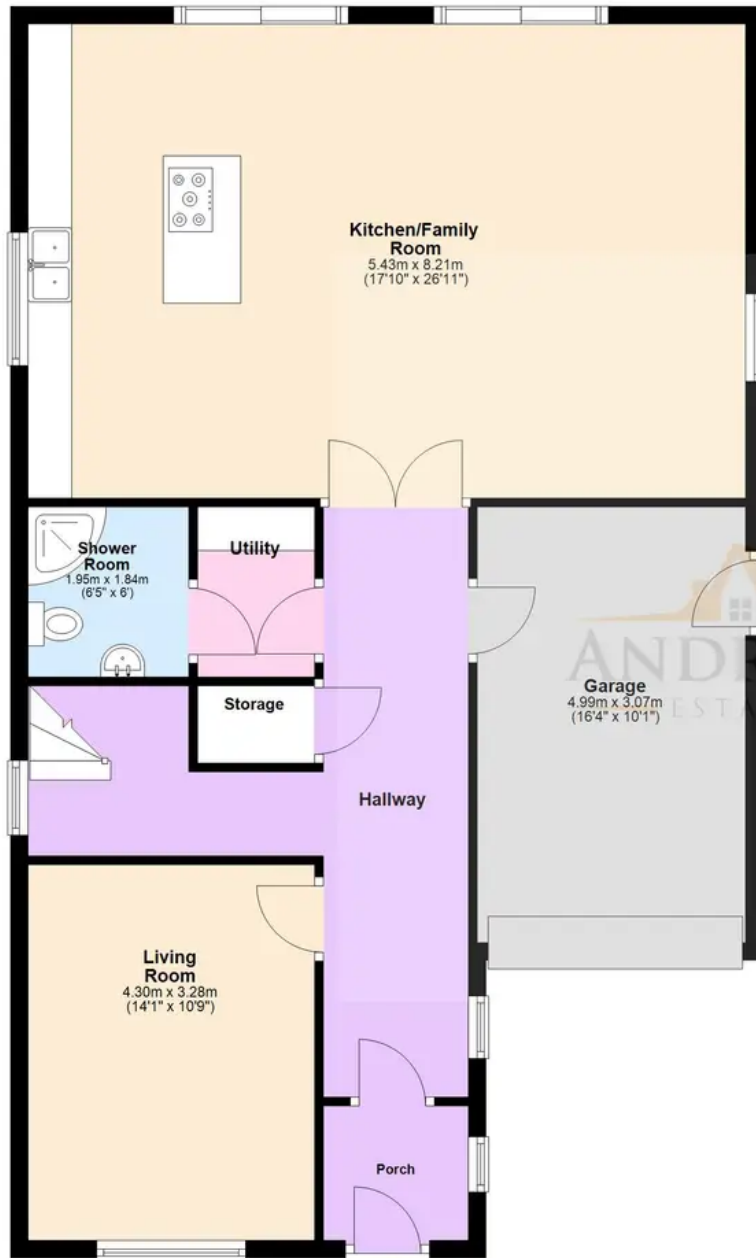

First Floor

Approx. 81.9 sq. metres (881.1 sq. feet)

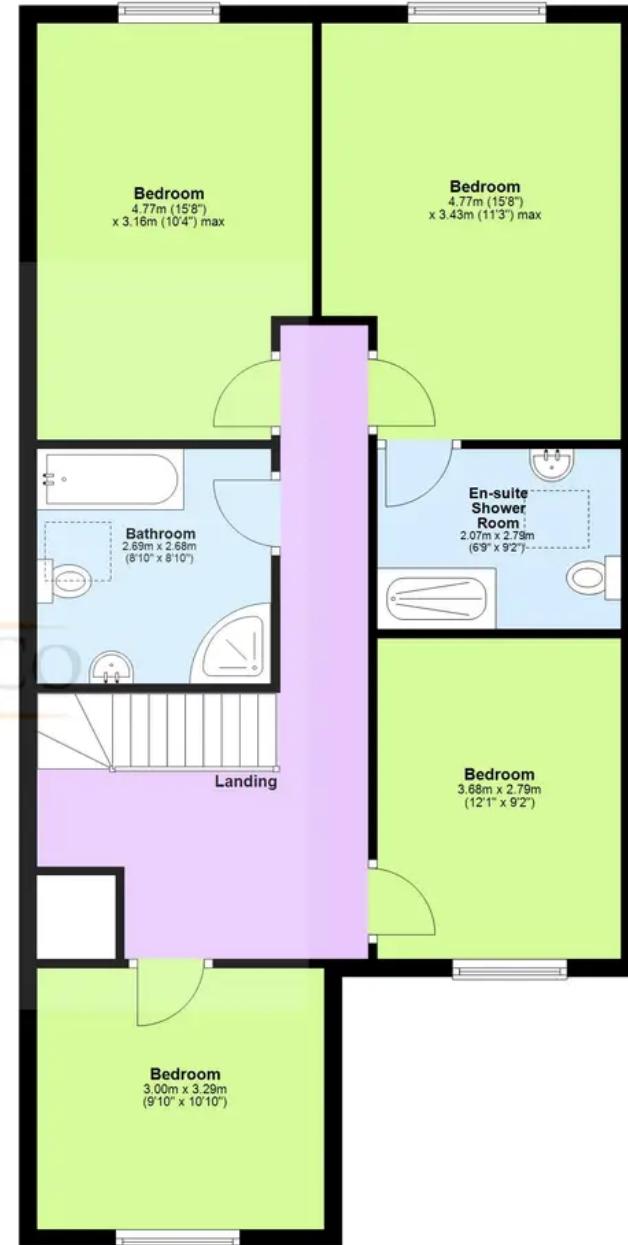

Total area: approx. 185.4 sq. metres (1995.6 sq. feet)

Plans are for layout purposes only and not drawn to scale, with any doors, windows and other internal features merely intended as a guide.
Plan produced using PlanUp.

These particulars are intended to give a fair and reliable description of the property but no responsibility for any inaccuracy or error can be accepted and do not constitute an offer or contract. We have not tested any services or appliances (including central heating if fitted) referred to in these particulars and purchasers are advised to satisfy themselves as to the working order and condition, if a property is unoccupied at any time there may be reconnection charges for any switched off/disconnected or drained services or appliances. All measurements are approximate.



Andrew & Co Estate Agents - New Romney

01797 362898

newromney@andrewandco.co.uk

