



Dunlin Court Cedar Crescent, St. Marys Bay

£220,000 Leasehold

Top Floor Apartment • Two Double Bedrooms • Sea Views • Balcony • Large Living Space • Garage en bloc • Communal Gardens • Close to Local Shops



Entrance Hall

Living Room

16' 7" x 16' 1" (5.05m x 4.91m)

Kitchen

10' 1" x 13' 1" (3.08m x 3.99m)

Bathroom

7' 10" x 5' 10" (2.38m x 1.78m)

Bedroom

10' 8" x 13' 3" (3.25m x 4.03m)

Bedroom

10' 8" x 9' 1" (3.25m x 2.78m)

Balcony



Second Floor

Approx. 71.8 sq. metres (773.4 sq. feet)

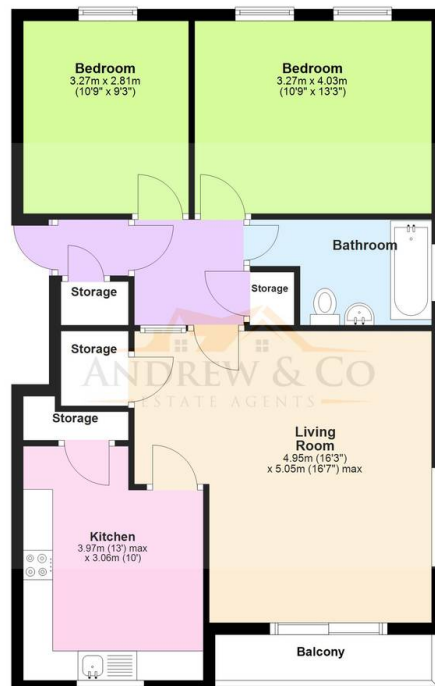

Total area: approx. 71.8 sq. metres (773.4 sq. feet)

Plans are for layout purposes only and not drawn to scale, with any doors, windows and other internal features merely intended as a guide.
Plan produced using PlanUp.

Second Floor

Approx. 71.8 sq. metres (773.4 sq. feet)



Total area: approx. 71.8 sq. metres (773.4 sq. feet)

Plans are for layout purposes only and not drawn to scale, with any doors, windows and other internal features merely intended as a guide.
Plan produced using PlanUp.

You can include any text here. The text can be modified upon generating your brochure.



You can include any text here. The text can be modified upon generating your brochure.