



Stonebridge Villas Ashford Road, New Romney

£250,000 Freehold

Two Bedroom • Terraced Cottage • Two Reception Rooms • Off Street Parking • Pretty Rear Garden • Loft Room
• Chain Free • Log Burner





Ground Floor

Approx. 48.2 sq. metres (518.3 sq. feet)



First Floor

Approx. 42.3 sq. metres (455.6 sq. feet)



Second Floor

Approx. 21.0 sq. metres (226.1 sq. feet)

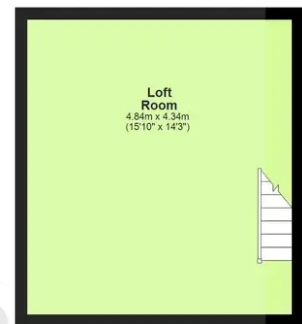

Total area: approx. 111.5 sq. metres (1200.1 sq. feet)

Plans are for layout purposes only and not drawn to scale, with any doors, windows and other internal features merely intended as a guide.
Plan produced using PlanUp.