

SIGNATURE

NORTH EAST

OFFICIALLY RATED THE NO.1 ESTATE AGENT IN THE NORTH EAST





📍 Wansbeck Avenue, Blyth NE24 3LF

Wansbeck Avenue, Blyth NE24 3LF

Offers Over £190,000

Signature North East welcomes you to this charming three-bedroom semi-detached home, ideally located in the heart of Blyth. Perfectly positioned to enjoy both everyday convenience and scenic coastal walks, with amenities and the beach just a short distance away. The property has been rewired and benefits from a number of improvements throughout, creating a fresh and welcoming environment.

As you enter the property, you're greeted by a bright hallway leading into the spacious open-plan living/dining area. This space is enhanced by a large bay window and sliding doors that open onto the rear garden, filling the room with natural light. The kitchen features stylish wall and base units with sleek countertops, as well as integrated oven and hob. A convenient utility room sits just off the kitchen for added practicality.

Upstairs, you'll find three well-sized bedrooms, two of which are spacious doubles, ideal for families or those working from home. The family bathroom is tastefully fitted and includes a bathtub, overhead shower, wash basin and WC. The first floor has also been upgraded with new radiators, ensuring the home remains warm and efficient year-round.

The garden has been carefully maintained and was improved just two years ago, featuring a lawn and raised patio area, ideal for outdoor relaxation. A garage and private driveway provide off-street parking, with visitor bays available nearby for added convenience.



PLEASE NOTE THAT THE VENDOR HAS CERTIFIED THE PROPERTY INFORMATION AND IMAGES.

PROPERTY FLOORPLAN

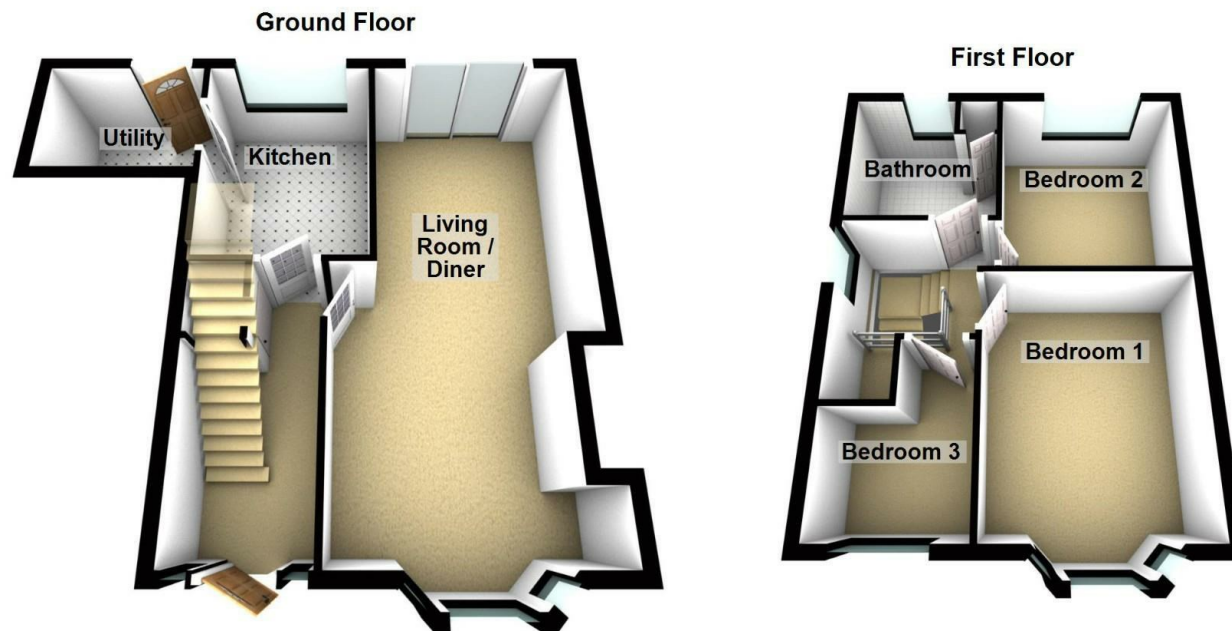

Total area: approx. 85.1 sq. metres (916.3 sq. feet)

Measurements:

Living Room / Diner
23'10" x 11'11"

Kitchen
10'8" x 8'3"

Utility
5'11" x 7'10"

Bedroom One
12'7" x 10'9"

Bedroom Two
11'0" x 9'11"

Bedroom Three
9'7" x 7'2"

Bathroom
7'8" x 8'1"

Energy Efficiency Rating

	Current	Potential
Very energy efficient - lower running costs		
(92 plus) A		
(81-91) B		83
(69-80) C		
(55-68) D	67	
(39-54) E		
(21-38) F		
(1-20) G		
Not energy efficient - higher running costs		

England & Wales

EU Directive
2002/91/EC







More 5 Star Customer Reviews than any other Agent based in the North East on [allAgents.co.uk](https://allagents.co.uk)



SALES

LETTINGS

FINANCE

LAW

WE COVER THE WHOLE OF THE NORTH EAST

Whitley Bay
0191 251 3344

Cramlington
01670 897 213

Tynemouth
0191 296 6689

Morpeth
01670 513 966

Ponteland
01661 820 082

Wallsend
0191 432 4151

Alnwick
01665 511 800

Heaton
0191 432 4275

Forest Hall
0191 266 9966

Other locations
0191 640 3523

Newcastle
0191 640 2284

Durham
0191 303 8252

Gosforth
0191 640 3523

Sunderland
0191 543 6390

Whickham
0191 432 5102

Gateshead
0191 432 4294

Jesmond
0191 281 1037

Killingworth
0191 640 3602

Ryton
0191 413 9845

Head Office &
Lettings
0191 253 4815

*Highest recommended 5-star reviews than any other Estate Agent based in the North East on [allAgents.co.uk](https://allagents.co.uk) - The UK's Largest Customer Review Website for the Property Industry & Awarded Best Estate Agency 2018 & 2019 - North East England by SME News