

SIGNATURE

NORTH EAST

OFFICIALLY RATED THE NO.1 ESTATE AGENT IN THE NORTH EAST





📍 Preston Gate, North Shields NE29 9QB

Preston Gate, North Shields NE29 9QB

Offers Over £77,000

Signature North East is delighted to welcome to the market this charming one-bedroom upper-floor flat, ideally located in the heart of North Shields. This sought-after location offers residents excellent transport links, providing easy access to Newcastle and the surrounding areas. North Shields is home to an array of local shops, restaurants, and amenities, as well as popular attractions such as the historic Fish Quay, Royal Quays, and Clifford's Fort. With plenty of green spaces and a growing cultural scene, this area presents an ideal setting for both homeowners and investors alike.

Upon entering the property, you are welcomed into a central hallway, complete with additional storage facilities. The spacious living room is the first stop, offering ample room for desired furnishings, a large window allowing for plenty of natural light, and a bright, inviting atmosphere. Leading from the living room, the well-appointed kitchen provides generous space with a range of base and wall units, extensive countertop space, and integrated appliances, including an oven and hob, as well as a freestanding washing machine and fridge freezer. The living room also provides access to the spacious bedroom, which can comfortably accommodate a double or king-size bed and benefits from two fitted wardrobes. Adjacent to the bedroom, the large shower room features a shower cubicle, W.C., and hand basin.

Externally, the property boasts the convenience of on-site parking, along with a single garage located just a short walk away down a nearby pathway.

With its unbeatable location and excellent transport links, this property is an ideal opportunity for first-time buyers or investors looking to secure a fantastic rental property in a highly desirable area.



PLEASE NOTE THAT THE VENDOR HAS CERTIFIED THE PROPERTY INFORMATION AND IMAGES.

PROPERTY FLOORPLAN

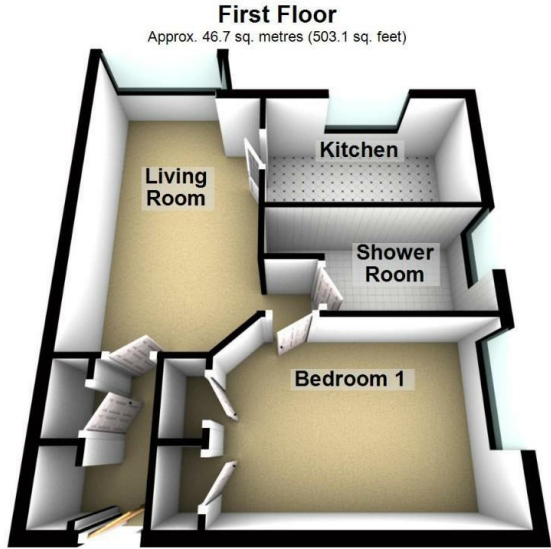

Total area: approx. 46.7 sq. metres (503.1 sq. feet)
Please be advised the floorplans are not drawn to scale and are to be used to give an idea of the layout of the property.
Plan produced using PlanUp.

Measurements:

Living Room
18'11" x 9'8"

Kitchen
11'5" x 6'9"

Bedroom
13'10" x 9'4"

Shower Room
11'0" x 5'8"

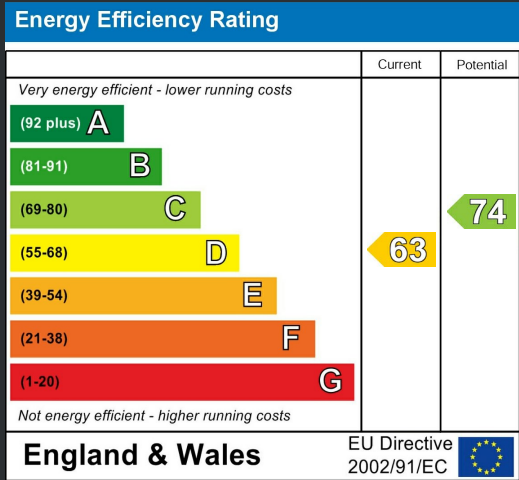





More 5 Star Customer Reviews than any other Agent based in the North East on [allAgents.co.uk](https://allagents.co.uk)



SALES

LETTINGS

FINANCE

LAW

WE COVER THE WHOLE OF THE NORTH EAST

Whitley Bay
0191 251 3344

Cramlington
01670 897 213

Tynemouth
0191 296 6689

Morpeth
01670 513 966

Ponteland
01661 820 082

Wallsend
0191 432 4151

Alnwick
01665 511 800

Heaton
0191 432 4275

Forest Hall
0191 266 9966

Other locations
0191 640 3523

Newcastle
0191 640 2284

Durham
0191 303 8252

Gosforth
0191 640 3523

Sunderland
0191 543 6390

Whickham
0191 432 5102

Gateshead
0191 432 4294

Jesmond
0191 281 1037

Killingworth
0191 640 3602

Ryton
0191 413 9845

Head Office &
Lettings
0191 253 4815

*Highest recommended 5-star reviews than any other Estate Agent based in the North East on [allAgents.co.uk](https://allagents.co.uk) - The UK's Largest Customer Review Website for the Property Industry & Awarded Best Estate Agency 2018 & 2019 - North East England by SME News